

# Assembly Instructions Whirlpool Bath T18

(10v20) eng

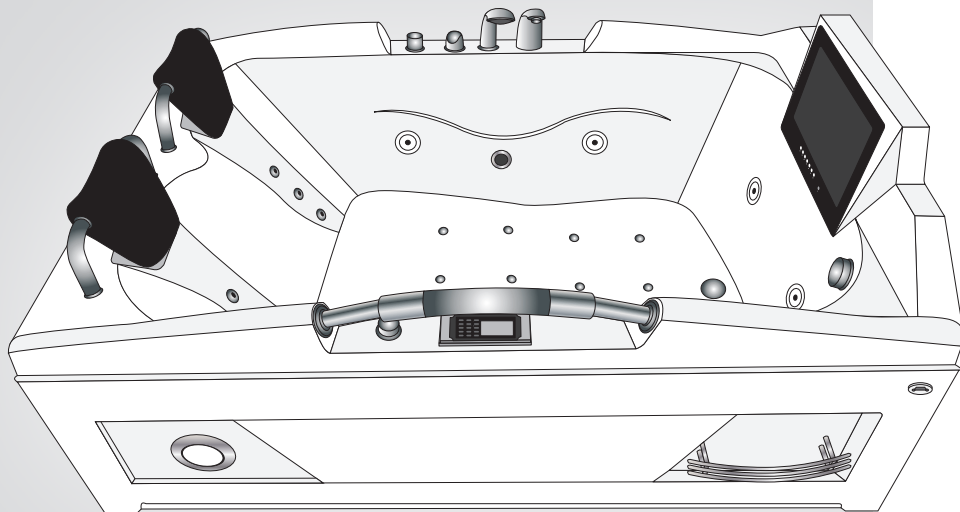

**Attention:** The pool should always be  
be done by two people!



## Foreword

Dear customer, we are pleased that you have chosen this product. Please observe all instructions before assembly and use and strictly follow the procedure below!

Please check the product for completeness first. If there is any damage, please send us a message with a short description and photos of the affected area. A responsible employee will contact you as soon as possible and find a solution together with you.

You have a 2-year legal warranty on all products.

## Important information

Please note: The product is designed exclusively for private use. Our products are subject to constant further development. This may result in changes to the design and the use of other components. We try to keep the following pages up to date. If you have any questions regarding the design, please contact us at +49 35795 - 179 600 or by e-mail at [kundenservice@seniorbad.de](mailto:kundenservice@seniorbad.de). We are very grateful for any suggestions for improvement.

### Please read the operating instructions carefully first!

If you still have questions about the assembly, we will be happy to help you personally. Complaints resulting from incorrect installation or use are excluded from the warranty!

Seals, hand showers, shower hoses and castors are wearing parts, therefore a warranty period of 6 months applies here. The costs for replacement are not covered. Illuminants are completely excluded from the warranty.

- Installation and assembly work should only be carried out by a skilled worker.
- Make sure that the bathtub is properly earthed. We recommend that any electrical connections be made by trained professionals.
- The permissible water pressure should be approx. between 4 and 6 bar.
- From a hardness level of 10° (German hardness) we recommend the installation of a softening device.
- Complaints based on limescale deposits are excluded from the warranty!

## Sealing areas under/behind the bathtub

### Sealing is compulsory - silicone is not enough!

The areas behind and under the bathtub must be tiled. Sealant joints - like silicone joints - are not waterproofing, but only maintenance and beauty joints! Only the use of bathtub sealing tapes or e.g. sheet sealants comply with this DIN.

### Waterproofing according to DIN 18534

„This standard is therefore not only addressed to the waterproofing specialist, but also to those who are responsible for the overall planning and execution of the building and its components, because the effect and durability of the waterproofing depend on the coordinated planning of all those involved.“

*You as the installer are responsible for reliable waterproofing alongside the planner and tiler. „The waterproofing must fulfil its function for the intended service life with sufficient reliability.“*

Waterproofing must be planned so that it functions for the entire duration of use. In a domestic bathroom, this can be an average of 20 to 25 years. In practice, this means laying tiles or a membrane waterproofing under the bath is mandatory. Note that the sealing area at the transition from the floor to the wall must be at least 10 cm high.

### Please note:

- The pool must not be permanently installed. It must be ensured that it can be moved away from the wall for maintenance work.
- The pool should be connected by an approved tradesman.
- The pool should be installed by a professional in accordance with these installation instructions. The electrical connection for the pool must be made by a certified electrician. This person must also ensure sufficient earthing to prevent accidents and malfunctions.
- Please have an electrician check the function of the residual current circuit breaker regularly.
- The statics of the floor must ensure that it can withstand the total weight of the pool, including water and one person.
- The feet of the pool must stand on a firm, stable surface. The floor must be level.
- Any damage found during unpacking must be reported to the dealer immediately; it is best to take photos and send them to the dealer

## Technical data

### Outside dimensions of the pool

188 cm Length  
120 cm Wide  
86 cm Hight (highest point - TV side)

### Hot and cold water connection

½ Inch max. 4 Bar  
Waist water HT 50mm

### Power connection

220-240 V  
50 Hz  
max. 4 A

### Massage pump air Massage pump water Heating

400 W  
1100 W  
1500 W

## Tools for the construction

Tools are not included in the package.

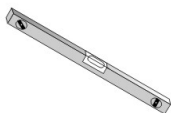

Spirit level

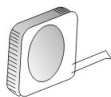

Measuring  
tape



Phillips / slotted  
screwdriver



Open-end spanner

## Dimension

Enough space for two people.

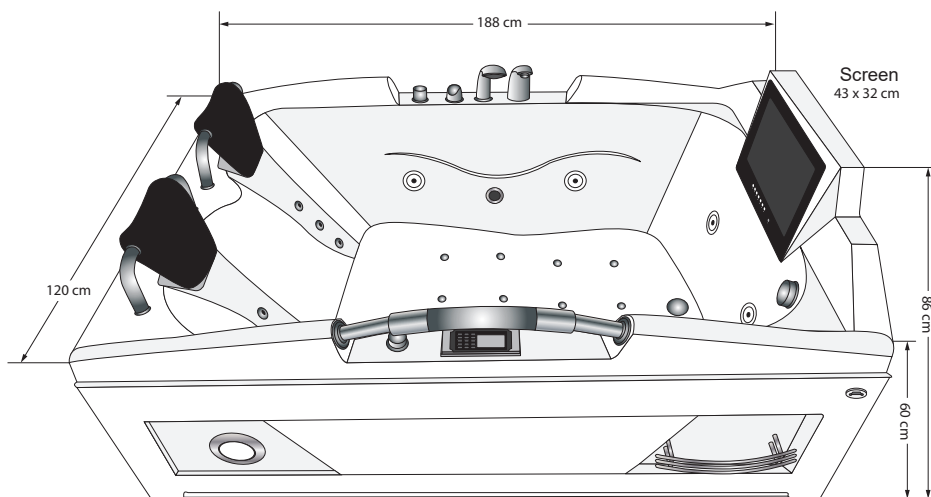

It is designed to stand in a corner. There are front skirts on the hull at the front and at the head end, only at the back and on the TV side it is not faced.

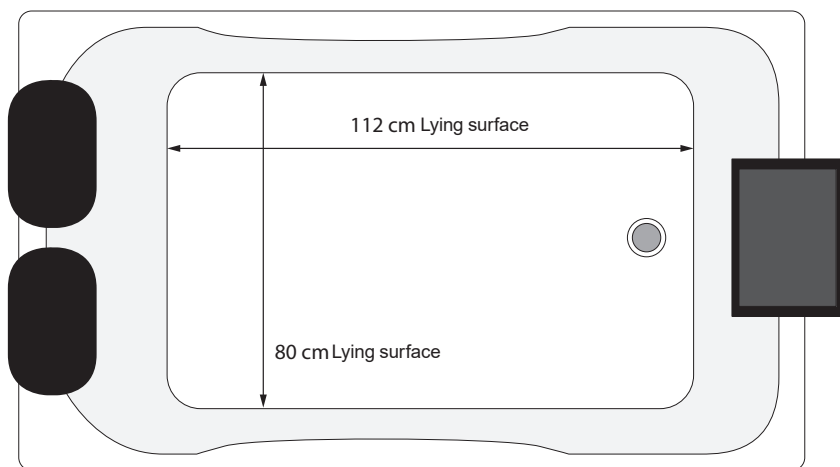

## Preparing the connections

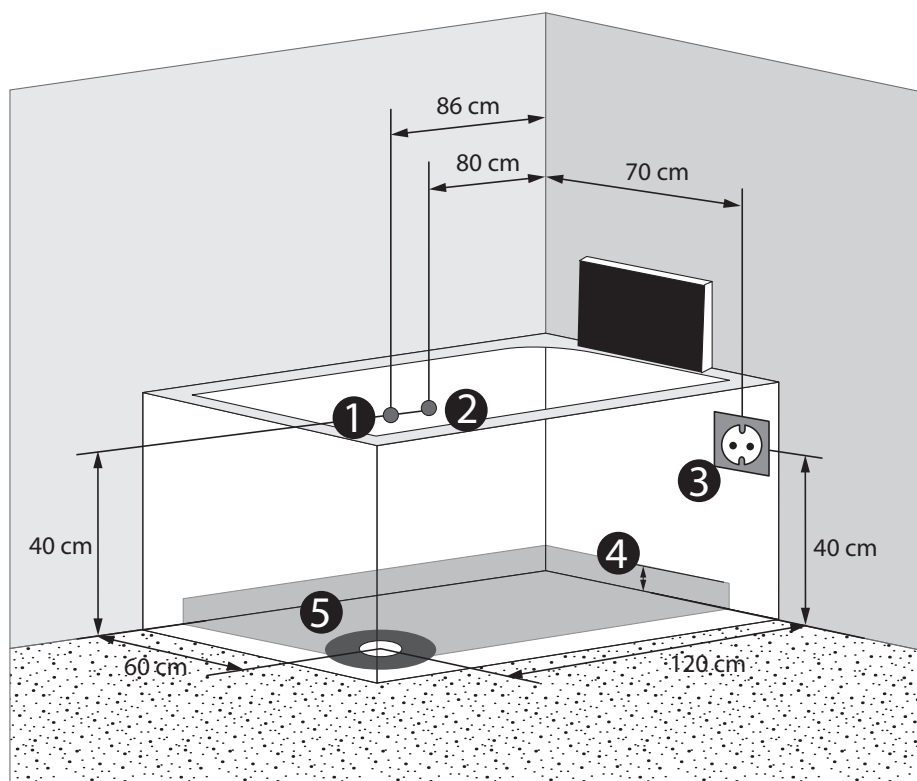

- ❶ Hot water 1/2 inch
- ❷ Cold water 1/2 inch
- ❸ Socket 230V 16A (or fixed socket)
- ❹ Grey area = possible area for the drain pipes, in the wall area the drain can be up to a max. height of 6 cm from the centre of the hole (German drain fitting e.g. Viega as well as two HT50 pipes 0.5m / 1.0m and one HT50 45 degree elbow, are included in the delivery).
- ❺ **ATTENTION:** leave the 15 cm Ø around the white siphon (dark grey area) under the drain free!

## Alignment

In order for the pool to stand straight, it is necessary to align the pool exactly with the help of a spirit level. Each foot is individually adjustable, so you can compensate for small irregularities in the floor. Please make sure that all feet are touching the ground and that the weight is evenly distributed on the ground.

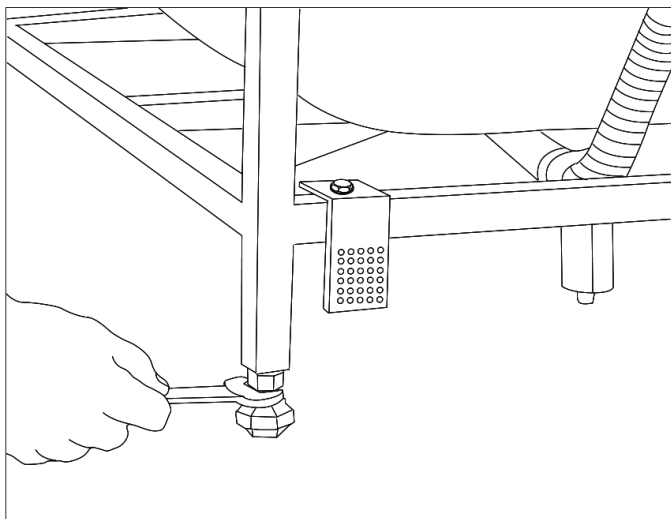

## Install drain pipes

The drain is in the floor, but the waste pipe can also be attached to a drain in the wall, but not higher than 6 cm so that the drain is still guaranteed. The HT 50 drain pipe used for this purpose is included in the delivery.

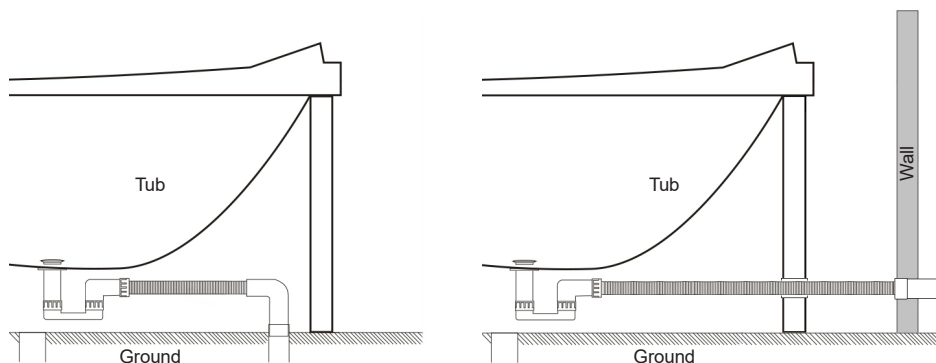

## Connecting the cold and hot water

After the drain has been installed, the water is now connected. The cold water connection is on the right and the hot water connection is on the left.

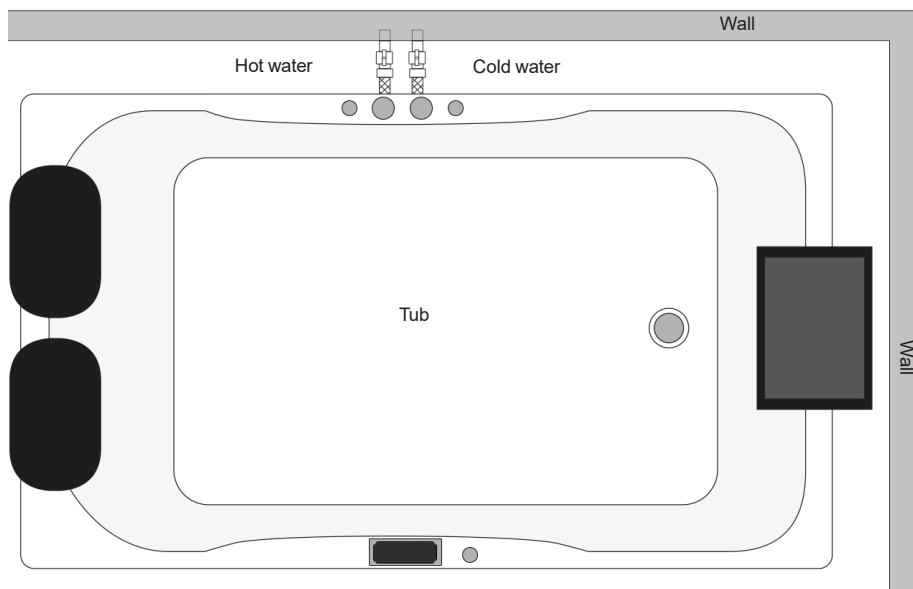

## Commissioning/leak test

For the leak test, please now connect the water and waste water with the hose connections. It is important that the tub continues to stand away from the wall so that you can still operate behind it. Before you put the pipe under water pressure, please note that it has only been pre-assembled by the factory to make it easier for you to set it up. It is absolutely necessary that you check all screw connections and tighten them if necessary. This applies to the nozzles and the clamps. Only when all this has been checked may you open the water inlet. Now test all the functions that have to do with water, one after the other. Check the hand shower and the function of the tap.

It is best to test this in pairs. One stands in front of or next to the bath, the other stands behind the bath and looks at the hose connection and the function that is currently being tested. If a screw connection is not properly tight, check whether the seal in the screw connection is properly seated and whether it is screwed tight enough. After the leak test, the electrical functions can now be tested. If the plug is plugged in, you can test the radio, whirlpool function, etc.



## Facing the tub

When the bathtub is finished and properly connected, the sides are faced.

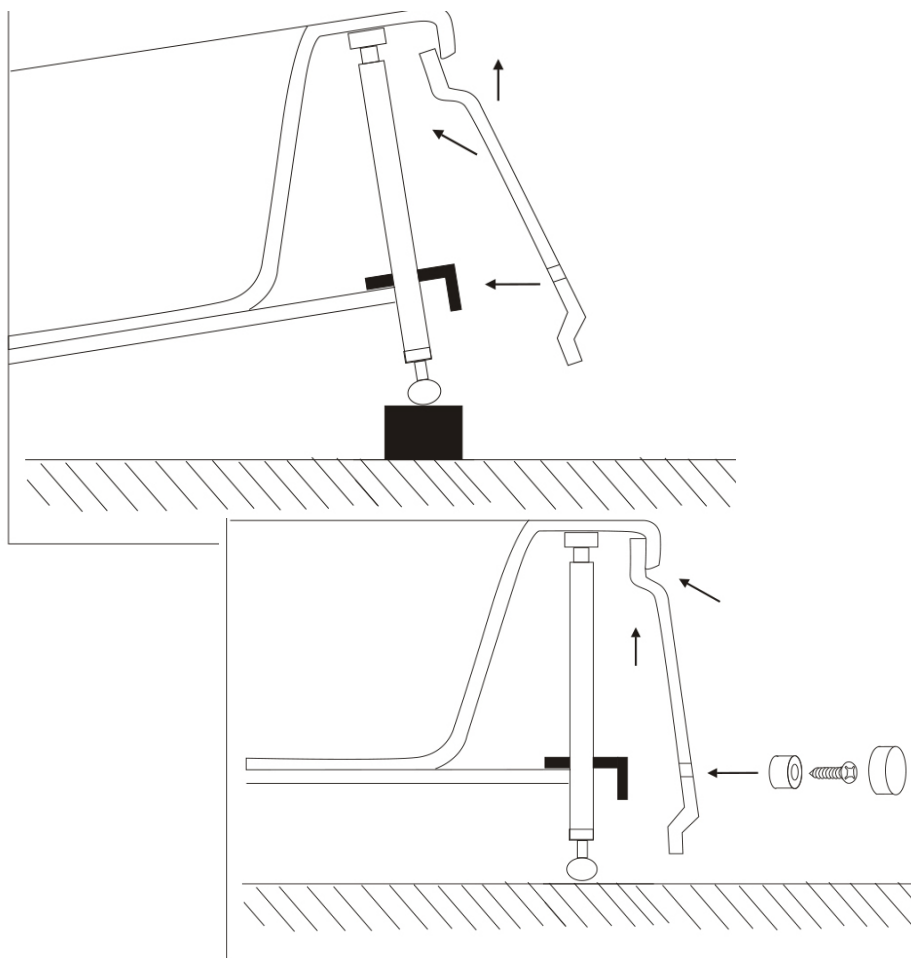

To do this, simply tilt the tub slightly and raise it in order to click the side parts underneath. Now just screw the sides together and place the cover cap on the screw.

## Sealing

You can now draw a silicone joint between the tub and the wall to seal it.

## Pool control panel/remote control

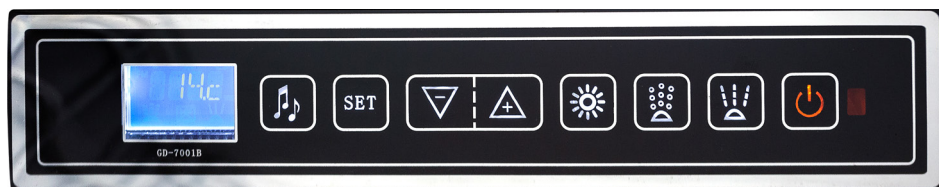

ON/OFF



Light ON/OFF



Radio ON/OFF



Air jets ON/OFF



Station search/temperature control Heating



Water jets ON/OFF, pressing the button twice lightly switches the heating on - use the arrow keys to select the temperature



Station memory

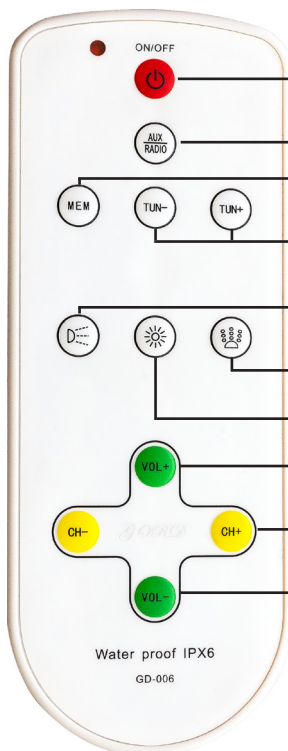

ON/OFF

Radio/USB input ON/OFF

Station memory

Channel search

Water jets ON/OFF

Air nozzles ON/OFF

Light ON/OFF

Volume +

Channel selection

Volume -

Water proof IPX6  
GD-006

## TV remote control

- 1 Power switch to switch on the TV set.
- 2 USB buttons to control playback from the USB input
- 3 HOME key to call up the first page again
- 4 INFO key to display information (e.g. channel no. TV system, PC frequency), top right corner of the screen
- 5 P. MODE key for the screen mode.
- 6 S. MODE key to switch on the sound mode.
- 7 SOURCE key to select specific sources such as TV, SV or other channels.
- 8 BROWSER to switch between browser mode and mouse.
- 9 ◀ ▶ ▴ ▾ Tasten for menu control for left, right, up and down.
- 10 MENU button to turn on the OSD menu or return to the previous menu.
- 11 EXIT button to exit the OSD menu.
- 12 VOL button to adjust the volume
- 13 CH key to select the channels in TV mode and to change the menu displays in OSD mode.
- 14 0-9 key to set the channel directly
- 15 ZOOM key to zoom the picture.

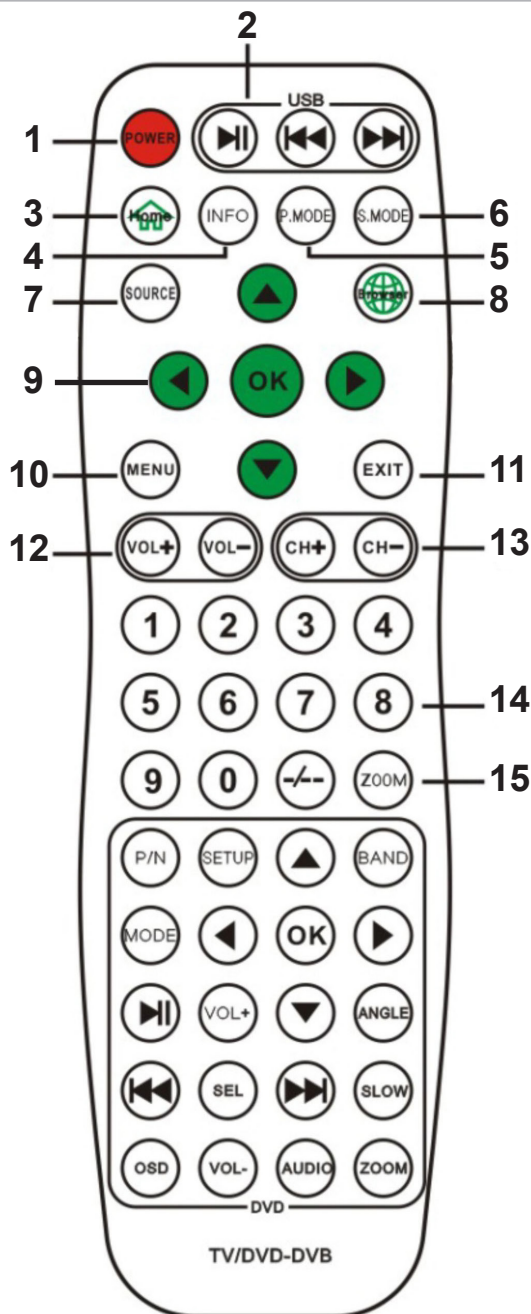

## Operating the TV set

### Input source



Select the source (Source 7) to display the input source menu. Select the desired input signal source with the ▼ ▲ (9) button and press OK.

### TV menu

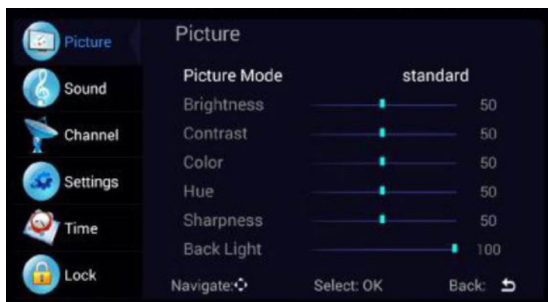

Press the „Menu“ button (10) to display the menu, use ▼ ▲ (9) to select the appropriate settings and press the right button ► to enter the appropriate settings.

### Picture

Select the picture menu (Picture) with the left and right buttons and press the OK button for the next operation. Use ▼ ▲ (9) to select the items. The picture mode can be switched to Standard/Soft/Brightness/User.

Furthermore, brightness, contrast, hue, saturation, sharpness, backlight and colour temperature can be set individually here.

## Sound

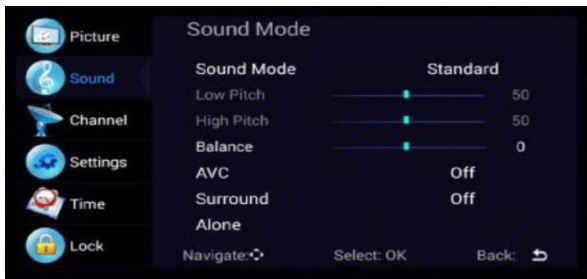

Select the sound menu with the ▼ ▲ (9).

The option „Sound mode“ offers the possibility to switch between music/movie/motion/user.

There are also options for automatic volume control and settings via the equaliser function.

## Search channels



Under the menu item Channel, you have the option of an automatic channel search or manual setting of the channels.

Please note that in most countries of the EU, the conventional TV signal has been switched off. It has been switched to digital. We therefore recommend that you connect the monitor via

the network (WIFI, LAN, Hotspot) and activate the Android box.

## ANDROID Part

Home screen

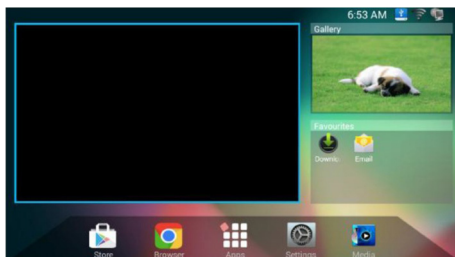

Application screen

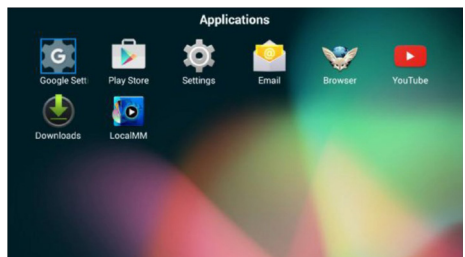

The start page can be divided into two parts. One part is the traditional TV portal, the gallery application and some of your favourite applications. In the upper right corner, the status of the network and the SD card is displayed. The other part is the navigation bar. Click on the corresponding icon to jump to Store, Browser, Apps, Settings or Media.

## Networks



Select the setting and press the OK button to display the interface of the „Android“ setting.

Select „WIFI“ and press the OK button to open it. A list of WiFi signals is displayed. Select the correct signal and enter your password.

You can also connect to

the Internet using a network cable or a local hotspot.

## Personal settings

In the ANDROID settings menu, you can set other important preferences such as language, date and time.

## Maintenance and cleaning of the pool

1. Clean the pool with a mild liquid detergent and a soft cloth. Caution: Never use acetone, cleaning agents containing ammonia or coarse-grained scouring agents!
2. Clear the pool drain regularly of hair and the like to prevent clogging.
3. Use an acrylic care product for the tub and the panel to protect the surface from scratches.
4. Small scratches can be polished with toothpaste and a soft cloth, for example.
5. Before using the whirlpool system for the first time, it should be rinsed through with disinfectant. Afterwards, it is sufficient to repeat the disinfection after approx. 5 baths. Disinfection should also be carried out if the whirlpool system is not used for a longer period of time.

## Warranty and service

You receive a 2-year warranty for our products. A warranty period of 6 months applies to wearing parts such as seals, hand showers and shower hoses. The costs for replacement are not covered. Spare parts can be ordered from our customer service.

E-mail: **kundenservice@seniorbad.de**

Online shop: **www.seniorbad.de**

Telephone: **+49 35795 - 179 600**

Fax: **+49 35795 - 179 699**

Defects that can be traced back to calciferous or iron-rich water are excluded from the warranty. Please describe the spare part exactly and state the exact pool type (e.g. T18). We are always open to your comments and suggestions.

## Note

Each pool is assembled, connected, tested and repacked at the factory for testing purposes. As our products are subjected to several checks during manufacture, small amounts of residual water may be present in parts of the product.

## Recycling

The disposal of the product's electronics is governed by the Waste Electrical and Electronic Equipment Act. The „old device“ must then be taken to an appropriate collection point.

We recommend that you remove the control unit, the lighting unit and the display and take these parts to the electrical/electronic collection point. The remaining large „residue“ can be treated as usual (local variant - such as bulky waste collection ...).

*Senior*  
**Bad** GmbH