

## Assembly instructions for senior bath tub

# S07

(01v23) eng

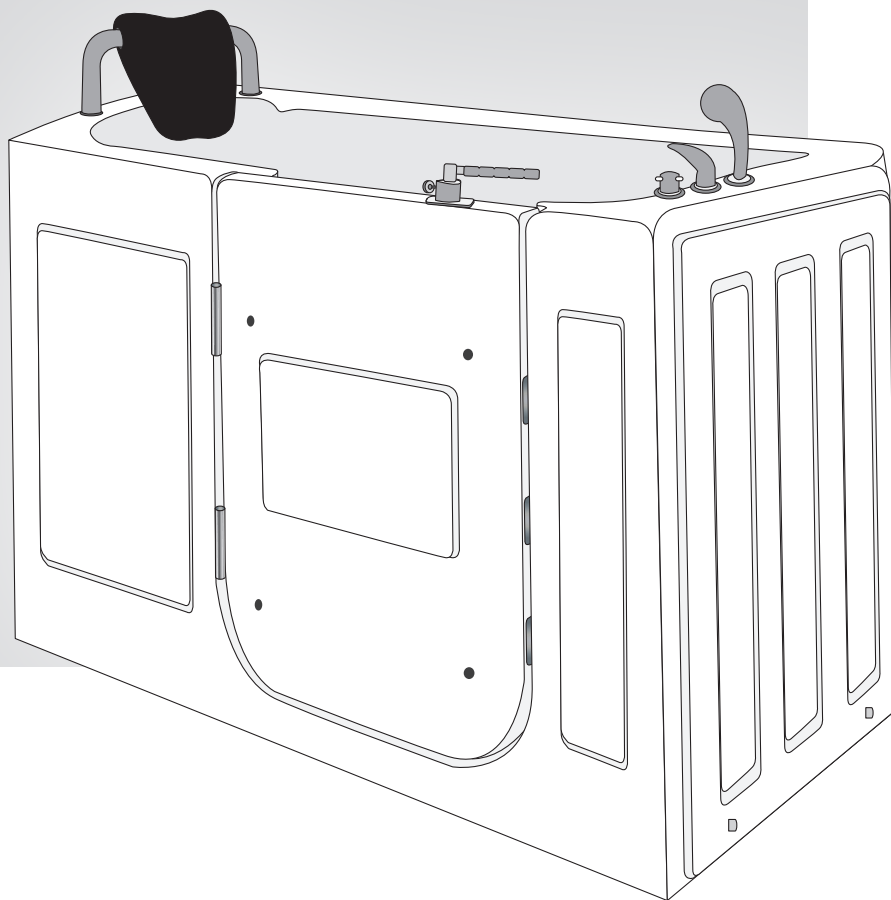

**Attention:** The assembly of this tub should be done by two people!



## Foreword

Dear customer, we are pleased that you have chosen this product. Please observe all instructions before assembly and use and strictly follow the procedure below!

Please check the product for completeness first. If there is any damage, please send us a message with a short description and photos of the affected area. A responsible employee will contact you as soon as possible and find a solution together with you.

You have a 2-year legal warranty on all products.

## Important information

Please note: The product is designed exclusively for private use. Our products are subject to constant further development. This may result in changes to the design and the use of other components. We try to keep the following pages up to date. If you have any questions regarding the design, please contact us at +49 35795 - 179 600 or by e-mail at [kundenservice@seniorbad.de](mailto:kundenservice@seniorbad.de). We are very grateful for any suggestions for improvement.

### Please read the operating instructions carefully first!

If you still have questions about the assembly, we will be happy to help you personally. Complaints resulting from incorrect installation or use are excluded from the warranty!

Seals, hand showers, shower hoses and castors are wearing parts, therefore a warranty period of 6 months applies here. The costs for replacement are not covered. Illuminants are completely excluded from the warranty.

- Installation and assembly work should only be carried out by a skilled worker.
- Make sure that the bathtub is properly earthed. We recommend that any electrical connections be made by trained professionals.
- The permissible water pressure should be approx. between 4 and 6 bar.
- From a hardness level of 10° (German hardness) we recommend the installation of a softening device.
- Complaints based on limescale deposits are excluded from the warranty!

## Sealing areas under/behind the bathtub

### Sealing is compulsory - silicone is not enough!

The areas behind and under the bathtub must be tiled. Sealant joints - like silicone joints - are not waterproofing, but only maintenance and beauty joints! Only the use of bathtub sealing tapes or e.g. sheet sealants comply with this DIN.

### Waterproofing according to DIN 18534

„This standard is therefore not only addressed to the waterproofing specialist, but also to those who are responsible for the overall planning and execution of the building and its components, because the effect and durability of the waterproofing depend on the coordinated planning of all those involved.“

*You as the installer are responsible for reliable waterproofing alongside the planner and tiler. „The waterproofing must fulfil its function for the intended service life with sufficient reliability.“*

Waterproofing must be planned so that it functions for the entire duration of use. In a domestic bathroom, this can be an average of 20 to 25 years. In practice, this means laying tiles or a membrane waterproofing under the bath is mandatory. Note that the sealing area at the transition from the floor to the wall must be at least 10 cm high.

### Please note:

- The pool must not be permanently installed. It must be ensured that it can be moved away from the wall for maintenance work.
- The pool should be connected by an approved tradesman.
- The pool should be installed by a professional in accordance with these installation instructions. The electrical connection for the pool must be made by a certified electrician. This person must also ensure sufficient earthing to prevent accidents and malfunctions.
- Please have an electrician check the function of the residual current circuit breaker regularly.
- The statics of the floor must ensure that it can withstand the total weight of the pool, including water and one person.
- The feet of the pool must stand on a firm, stable surface. The floor must be level.
- Any damage found during unpacking must be reported to the dealer immediately; it is best to take photos and send them to the dealer.

## Technical data

### Outside dimensions of the pool

140 cm Length  
76 cm Wide  
96 cm Height

### Pool interior dimensions

½ Inch max. 4 Bar  
Waste water HT 40mm

### Power connection

220-240 V  
50 Hz  
max. 12 A

### Massage pump water

900 W 4 A

### Max. water fill level

68 cm

### Inner dimensions of the pool

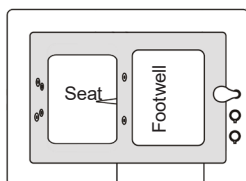

<b>Seat:</b>	45 cm	Wide
	38 cm	Depth
	40 cm	Hight
<b>Footwell:</b>	50 cm	Wide
	47 cm	Depth

### Entry height

19 cm

## Tools for assembly

Tools are not included in the package.



Spirit level



Open-end spanner



Screwdriver



Pipe wrench



Silicone cartridge

## Vorbereitung der Anschlüsse

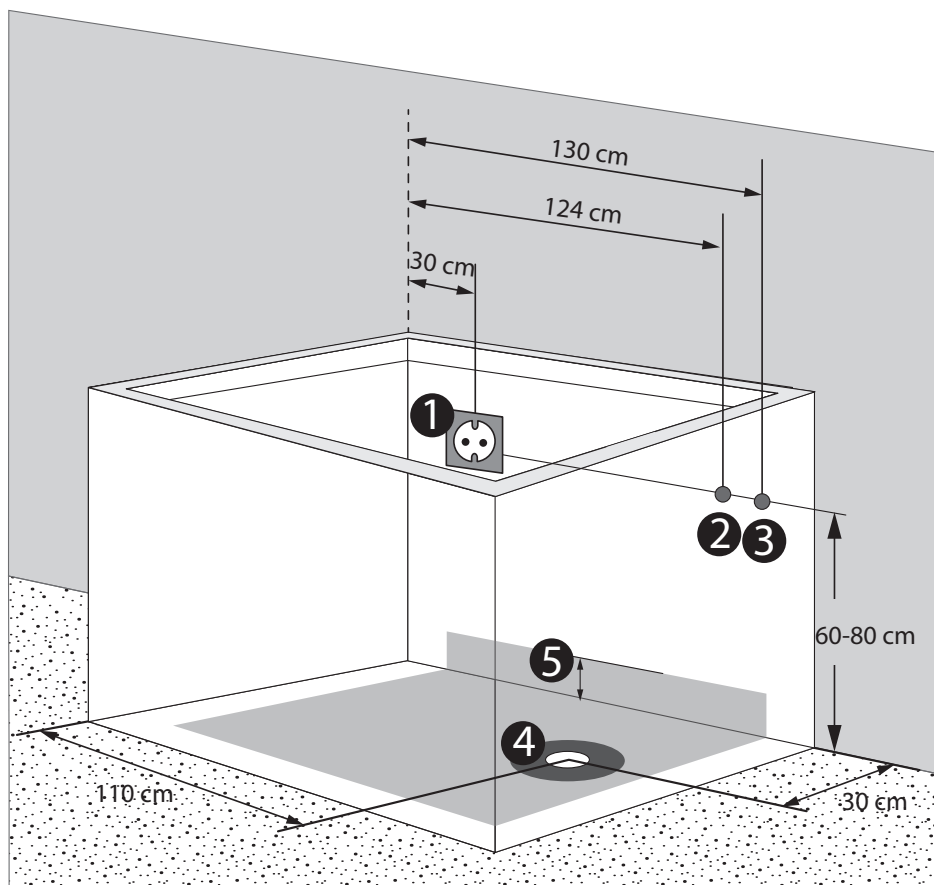

- 1** Socket 230V 16A (or fixed socket)
- 2** Hot water 1/2 inch
- 3** Cold water 1/2 inch
- 4** **ATTENTION:** leave the 15 cm Ø around the white siphon (dark grey area) under the shower tray free.  
**Grey area** = possible area for the drain pipes, in the wall area the drain can be up to a max. height of 6 cm to the centre of the hole
- 5** Drain set e.g. Viga as well as two HT50 pipes 0.5m/ 1.0m and one HT50 45 degree angle are included in the delivery.

## Designations

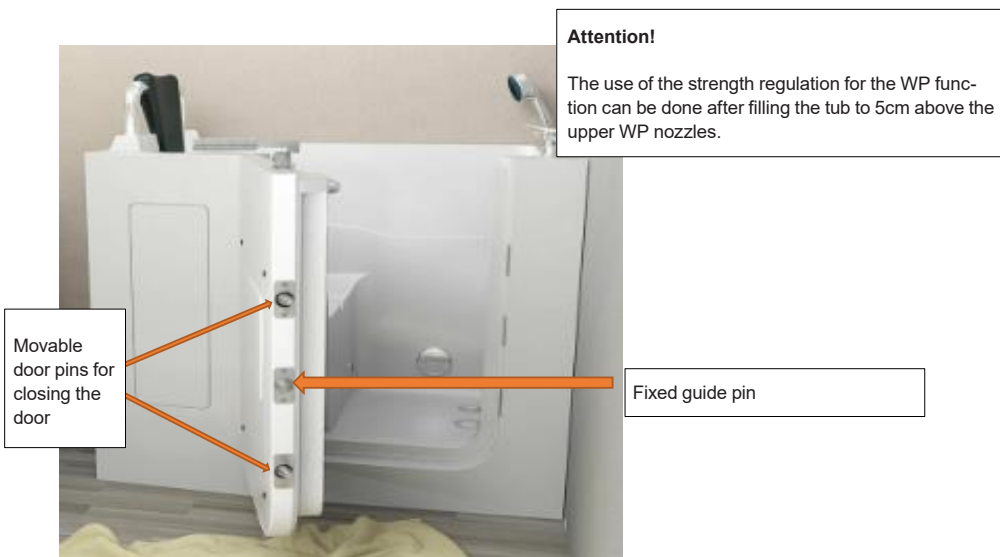
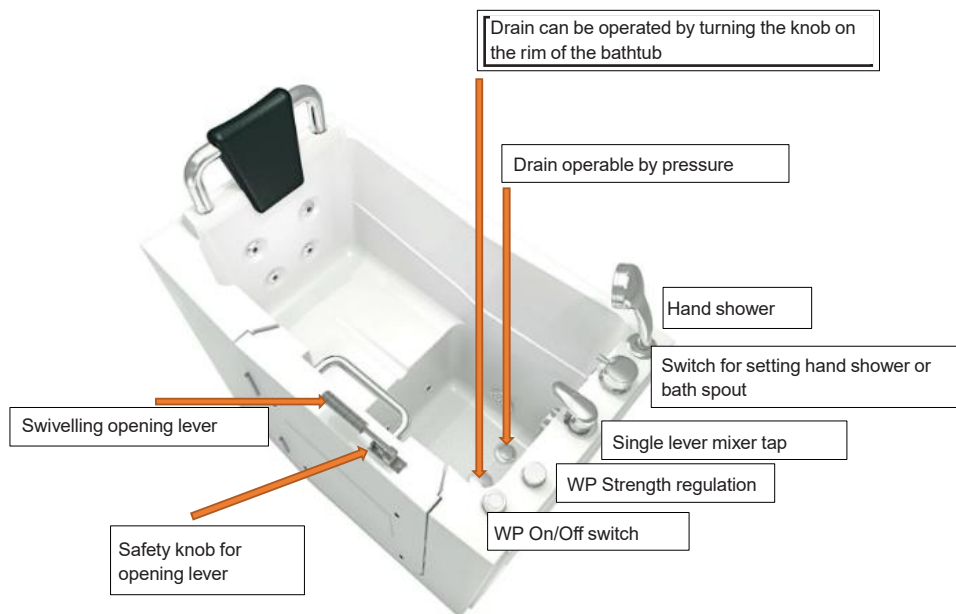

## Alignment

In order for the tub to stand straight, it is necessary to align the tub precisely with the help of a spirit level. Each foot is individually adjustable. This allows you to compensate for small unevenness of the floor. Please make absolutely sure that all feet are touching the floor and that the weight is evenly distributed on the floor.

When the tub is aligned and plumb, pull it forward again slightly to reach the back unobstructed.

### TIP:

*To make it easier to push the tub after it has been set up, we recommend that you apply a lubricant (e.g. a washing-up liquid) to all the feet. Then it will „glide“ much better on the tiles.*

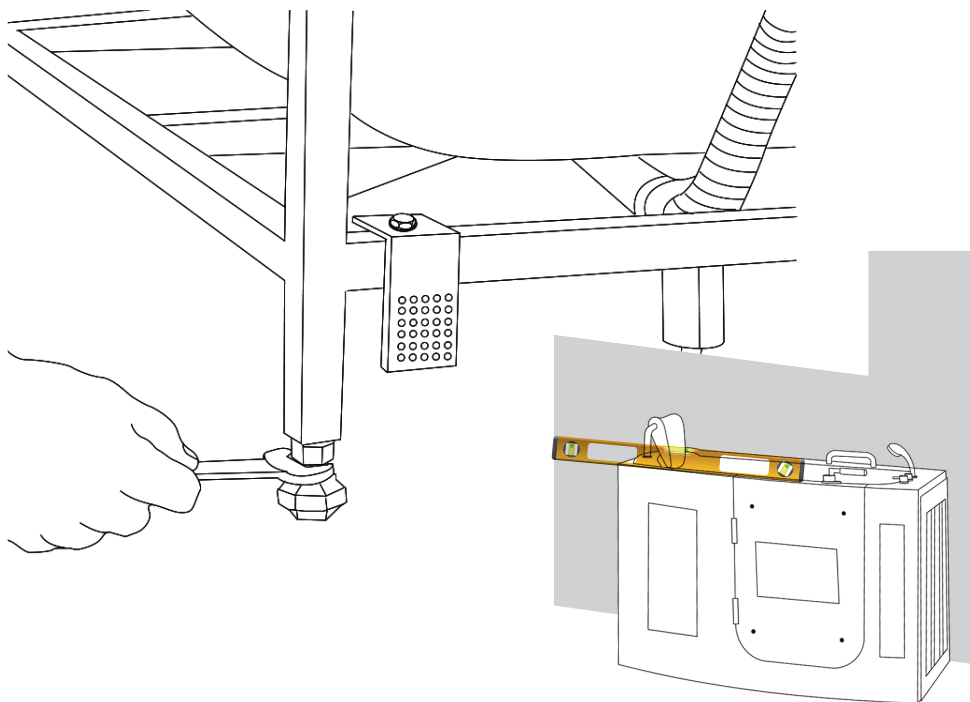

## Install drain pipes

The drain is in the floor, but the drain hose can also be attached to a drain in the wall, but no higher than 6 cm from the centre of the hole so that the drain is still granted.

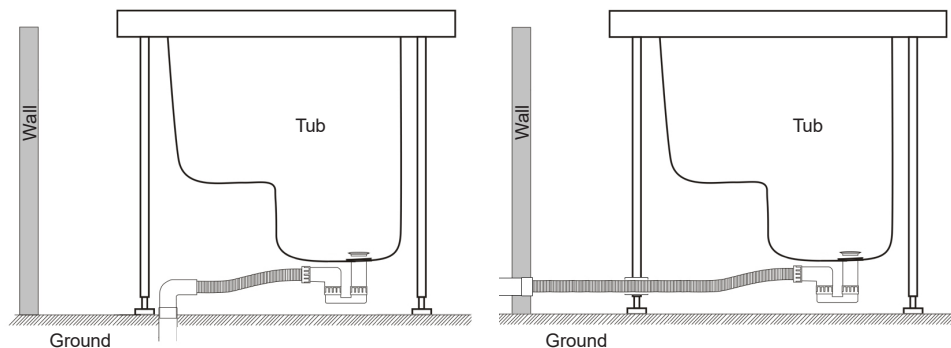

## Connecting cold and hot water

After the drain pipe has been installed, the water is now connected. The cold water connection is on the right and the hot water connection is on the left.

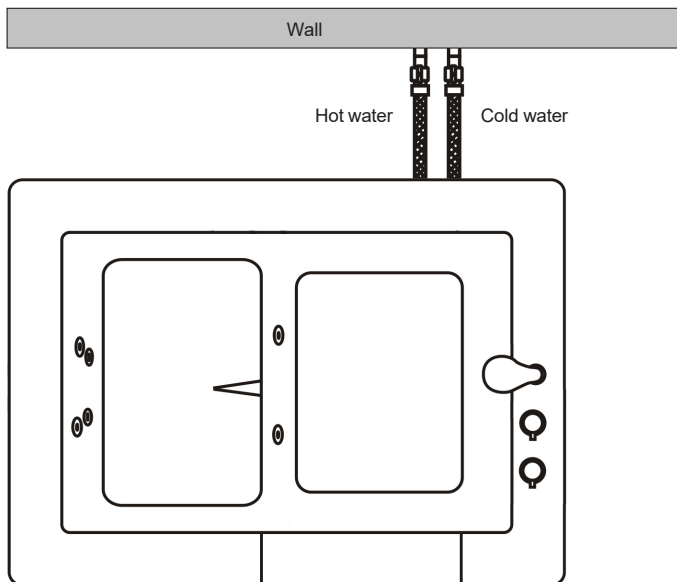



## Commissioning / leak test

For the leak test, please now connect the water and waste water with the hose connections. It is important that the tub continues to stand away from the wall so that you can still operate behind it. Before you put the pipe under water pressure, please note that it has only been pre-assembled by the factory to make it easier for you to set it up. It is absolutely necessary that you check all screw connections and tighten them if necessary. This applies to the nozzles and the clamps. Only when you have checked all this may you open the water inlet.

Now test all functions that have to do with water, one after the other. Check the hand shower and the function of the tap. It is best to check this in pairs. One stands in front of or next to the bath, the other stands behind the bath and looks at the hose connection and its function, which is being checked at the time. If a screw connection is not properly tight, check whether the seal in the screw connection is properly seated and whether it is screwed tight enough. After the leak test, the electrical functions can now be tested. To do this, insert the earthed plug into the earthed socket. Now you can test the whirlpool function (optional).

## Veneer tub

When the tub is finished and professionally connected, the sides are veneered.

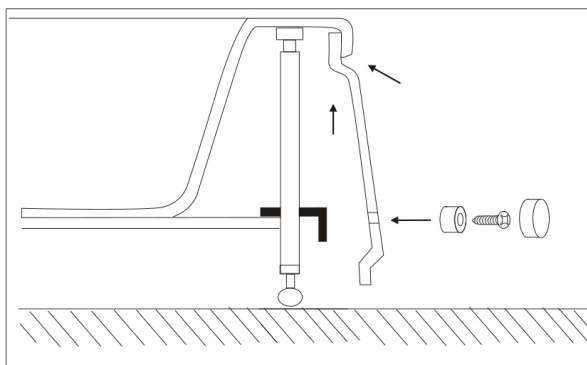
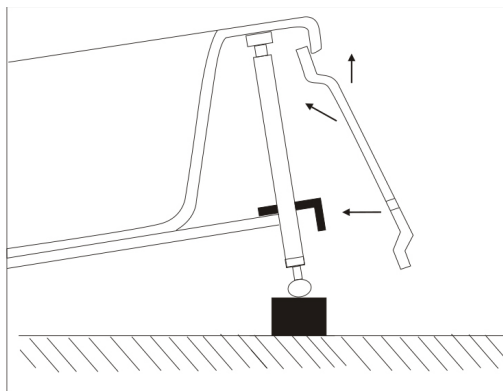

## Waterproofing

You can now draw a silicone joint between the tub and the bathroom walls to seal it.

## Maintenance and cleaning of the tub

1. Clean the tub with a mild liquid detergent and a soft cloth. Caution: Never use acetone, cleaning agents containing ammonia or coarse-grained scouring agents!
2. Clear the pool drain regularly of hair and the like to prevent clogging.
3. Use an acrylic care product for the tub and the back wall to protect the surface from scratches.
4. Small scratches can be polished out with toothpaste and a soft cloth, for example.
5. Before using the whirlpool system for the first time, it should be rinsed through with disinfectant. It is then sufficient to repeat the disinfection after approx. 5 baths. Disinfection should also follow if the whirlpool system is not used for a longer period of time.

## Warranty and service

You receive a 2-year warranty for our products. A warranty period of 6 months applies to wearing parts such as seals, hand showers and shower hoses. The costs for replacement are not covered. Spare parts can be ordered from our customer service.

E-mail: **kundenservice@seniorbad.de**

Online shop: **www.seniorbad.de**

Phone: **+49 35795 - 179 600**

Fax: **+49 35795 - 179 699**

Defects caused by calciferous or iron-rich water are excluded from the warranty. Please describe the spare part exactly - it is best to add the short designation (letter / number) used in this booklet as well as the exact pool type (e.g. S07). We are always open to your comments and suggestions.

## Note

Each pool is assembled, connected, tested and repacked at the factory for testing purposes. As our products undergo several checks during manufacture, small amounts of residual water may be present in parts of the product.

## Recycling

The disposal of the product's electronics is governed by the Waste Electrical and Electronic Equipment Act. The „old device“ must then be taken to an appropriate collection point. We recommend that you remove the control unit, the lighting unit and the display and take these parts to the electrical/electronic collection point. The remaining large „residue“ can be treated as usual (local variant - such as bulky waste collection ...).

*Senior*  
**Bad**<sub>GmbH</sub>