

## Assembly Instructions Whirlpool Bath

# K05

(04v24) eng

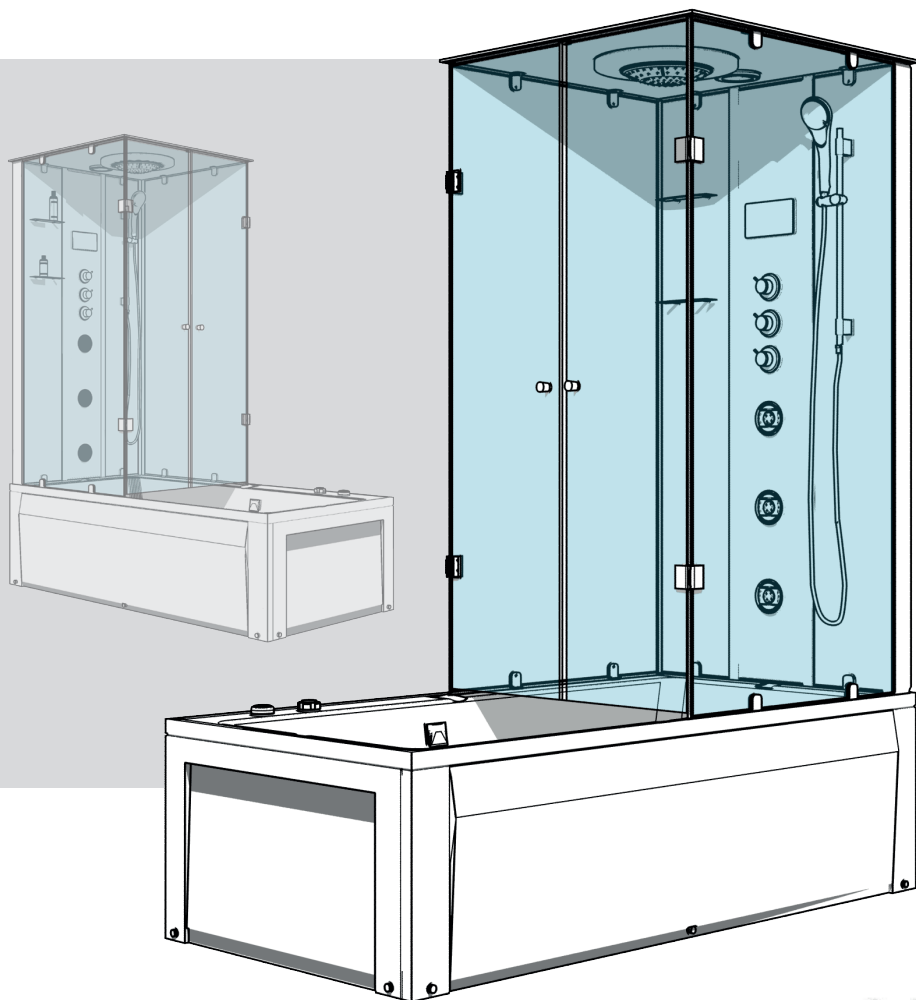

**Attention:** The assembly of this pool should be done by two people!



## Foreword

Dear customer, we are pleased that you have chosen this product. Please observe all instructions before assembly and use and strictly follow the procedure below!

Please check the product for completeness first. If there is any damage, please send us a message with a short description and photos of the affected area. A responsible employee will contact you as soon as possible and find a solution together with you.

You have a 2-year legal warranty on all products.

## Important information

Please note: The product is designed exclusively for private use. Our products are subject to constant further development. This may result in changes to the design and the use of other components. We try to keep the following pages up to date. If you have any questions regarding the design, please contact us at +49 35795 - 179 600 or by e-mail at [kundenservice@seniorbad.de](mailto:kundenservice@seniorbad.de). We are very grateful for any suggestions for improvement.

### Please read the operating instructions carefully first!

If you still have questions about the assembly, we will be happy to help you personally. Complaints resulting from incorrect installation or use are excluded from the warranty!

Seals, hand showers, shower hoses and castors are wearing parts, therefore a warranty period of 6 months applies here. The costs for replacement are not covered. Illuminants are completely excluded from the warranty.

- Installation and assembly work should only be carried out by a skilled worker.
- Make sure that the bathtub is properly earthed. We recommend that any electrical connections be made by trained professionals.
- The permissible water pressure should be approx. between 4 and 6 bar.
- From a hardness level of 10° (German hardness) we recommend the installation of a softening device.
- Complaints based on limescale deposits are excluded from the warranty!

## Sealing areas under/behind the bathtub

### Sealing is compulsory - silicone is not enough!

The areas behind and under the bathtub must be tiled. Sealant joints - like silicone joints - are not waterproofing, but only maintenance and beauty joints! Only the use of bathtub sealing tapes or e.g. sheet sealants comply with this DIN.

### Waterproofing according to DIN 18534

„This standard is therefore not only addressed to the waterproofing specialist, but also to those who are responsible for the overall planning and execution of the building and its components, because the effect and durability of the waterproofing depend on the coordinated planning of all those involved.“

*You as the installer are responsible for reliable waterproofing alongside the planner and tiler. „The waterproofing must fulfil its function for the intended service life with sufficient reliability.“*

Waterproofing must be planned so that it functions for the entire duration of use. In a domestic bathroom, this can be an average of 20 to 25 years. In practice, this means laying tiles or a membrane waterproofing under the bath is mandatory. Note that the sealing area at the transition from the floor to the wall must be at least 10 cm high.

### Please note:

- The pool must not be permanently installed. It must be ensured that it can be moved away from the wall for maintenance work.
- The pool should be connected by an approved tradesman.
- The pool should be installed by a professional in accordance with these installation instructions. The electrical connection for the pool must be made by a certified electrician. This person must also ensure sufficient earthing to prevent accidents and malfunctions.
- Please have an electrician check the function of the residual current circuit breaker regularly.
- The statics of the floor must ensure that it can withstand the total weight of the pool, including water and one person.
- The feet of the pool must stand on a firm, stable surface. The floor must be level.
- Any damage found during unpacking must be reported to the dealer immediately; it is best to take photos and send them to the dealer

## Safety instructions

- Electrical appliances may not be brought into the shower!
- The shower may only be used by children under the supervision of an adult and the supervisor must be familiar with the use of the shower.
- Do not topple or stack the appliance during storage.
- Never store together with organic solvents such as formaldehyde. Store in a dry and cool place.
- Do not store outdoors.
- We recommend thorough cleaning and a test of all functions before using the shower. Familiarise yourself with the operation BEFORE use!
- After a long period of inactivity, rinse the pipes of the head, body and hand shower as well as the foot massage (\*depending on the model) with hot water by opening the tap. Ensure that elements susceptible to limescale are regularly maintained, cleaned and descaled.

## Technical data

### Outside dimensions of the pool

180 cm Length  
90 cm Wide  
53 cm Height

### Hot and cold water connection

½ inch max. 4 Bar  
Waist water HT 40mm

### Power connection

220-240 V  
50 Hz  
max. 4 A

### Massage pump water

750 W

### Max. water fill level

32 cm

## Tools for assembly

Tools are not included in the package.

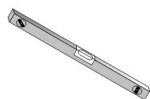

Spirit level



Drilling machine



Measuring  
tape



Phillips / slotted  
screwdriver



Open-end spanner

## Check completeness!

Please check for completeness. If you do not find something immediately, please check again carefully. Small parts in particular are easily overlooked due to the large number of parts and the mass of the packaging. Please do not dispose of the packaging until you are sure that it does not contain any small parts.

## Product components

**A**

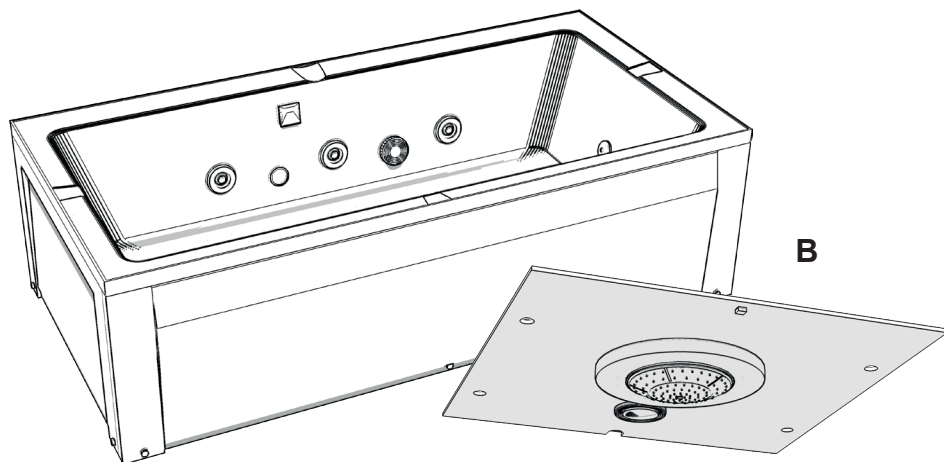

**C**

**D**

**E**

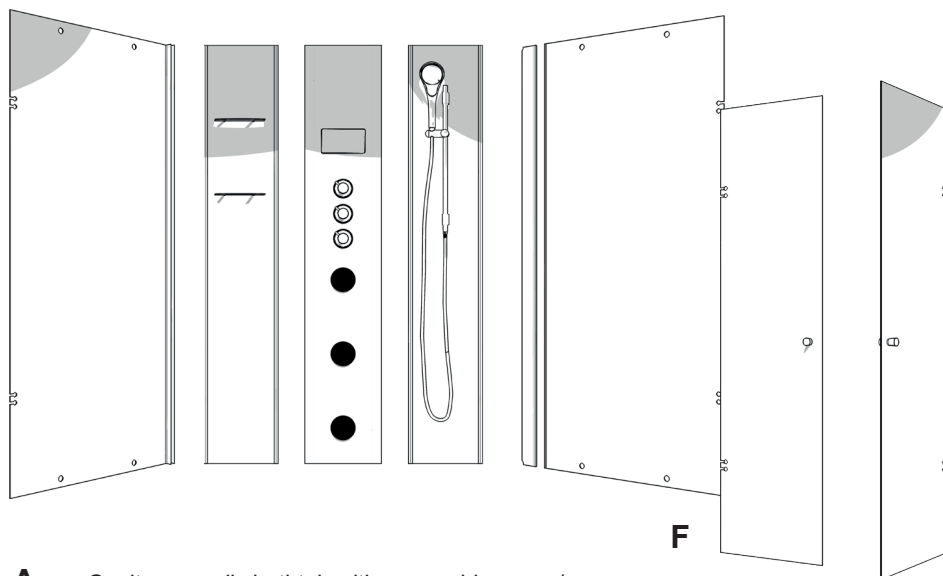

**A**

Sanitary acrylic bathtub with removable apron/cover

**B**

Cover with integrated rain shower, lamp and loudspeaker (according to the equipment of your model)

**C**

Side panel long bath tub edge at the rear

**D** Shower panel and back panels short tub edge: The panel is equipped with the back massage, the fitting and optionally with the control display. Please note that the shower panel has only been pre-assembled by the factory to make it easier for you to assemble. It is absolutely necessary that you check all screw connections and tighten them if necessary. This applies to the nozzles, the hoses on the fitting and the clamps.

**E** Glass side panel Long bath tub edge at the front and cover rail

**F** Doors left and right

\*Please note that points C and E are reversed in the right-hand version.

**B**

**C+E**

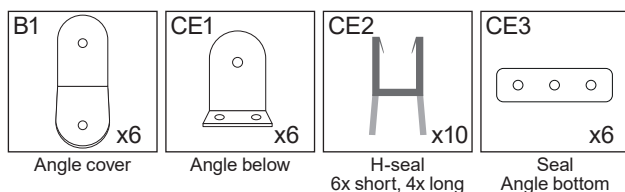

**D**

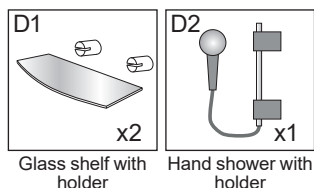

**F**

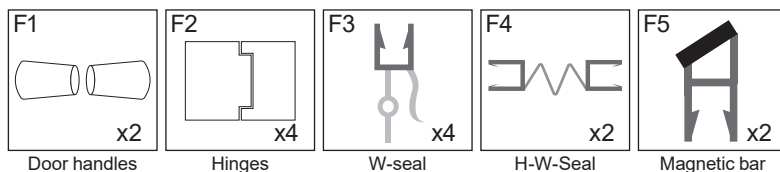

**G**

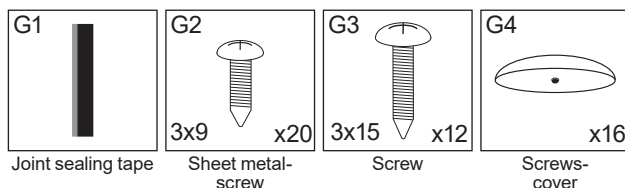

## Designations

### Tub

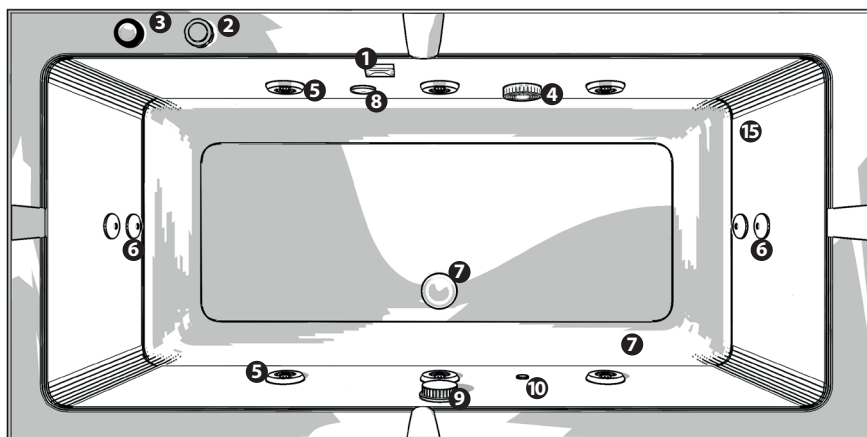

- |                                    |                             |
|------------------------------------|-----------------------------|
| <b>1</b> Water inlet               | <b>6</b> Massage jets small |
| <b>2</b> Massage setting           | <b>7</b> Drain              |
| <b>3</b> Whirlpool function on/off | <b>8</b> Colour light       |
| <b>4</b> Water suction             | <b>9</b> Drain opener       |
| <b>5</b> Massage jets large        | <b>10</b> Ozone cleaning    |

### Duschkabine

- |   |
|---|
| <b>1</b> Rain shower and light                |
| <b>2</b> Loudspeaker                          |
| <b>3</b> Hand shower                          |
| <b>4</b> Display                              |
| <b>5</b> Thermostat or single-lever mixer set |
| <b>6</b> Massage jets                         |
| <b>7</b> Glass shelves                        |

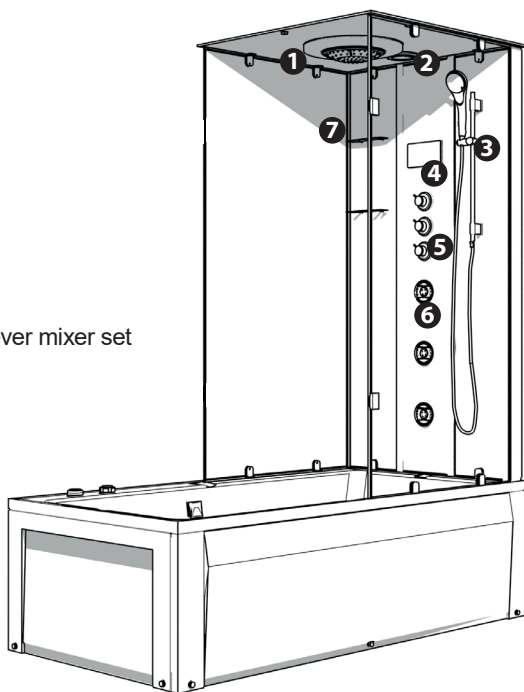



## Preparing the connections

### Left variant

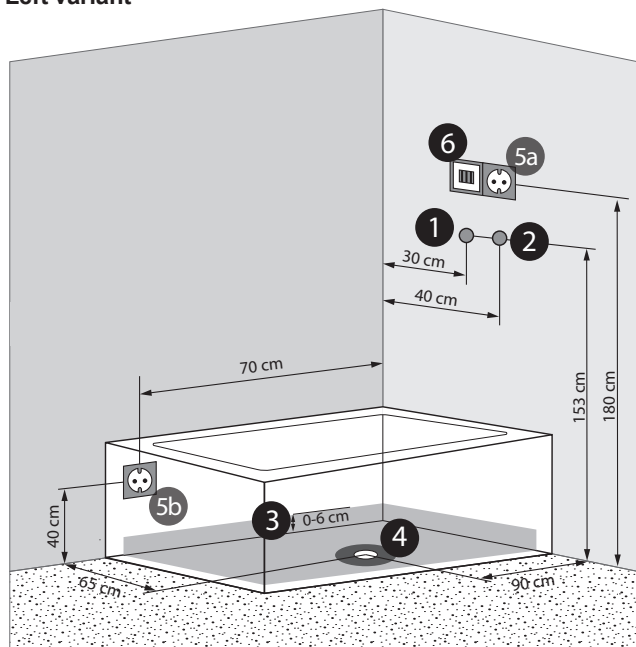

- ❶ Hot water 1/2 inch
- ❷ Cold water 1/2 inch

Connections can also be on the opposite side

- ❸ **Grey area** = possible area for the drain pipes, in the wall area the drain can be up to a max. height of 6 cm from the centre of the hole

Connection of waste water via a supplied HT50 pipe

- ❹ **ATTENTION:** leave the 15 cm Ø around the white siphon (dark grey area) under the drain free.

- ❺a Socket 230V 16A (or fixed socket) only for variant with radio
- ❺b Socket 230V 16A (or fixed socket) only for version with whirlpool tub

- ❻ Telephone connection

### Right variant

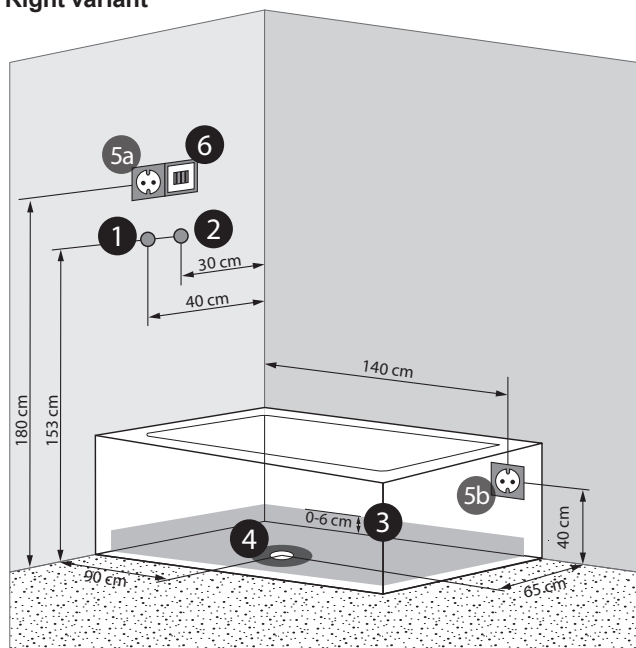

## Setting up and aligning the tub

Remove the skirt/panel and place the bathtub where you want it to stand later. Align it with the help of a spirit level. Then pull the tub approx. 40-50 cm out of the corner. This is necessary so that you can mount it on the back later.

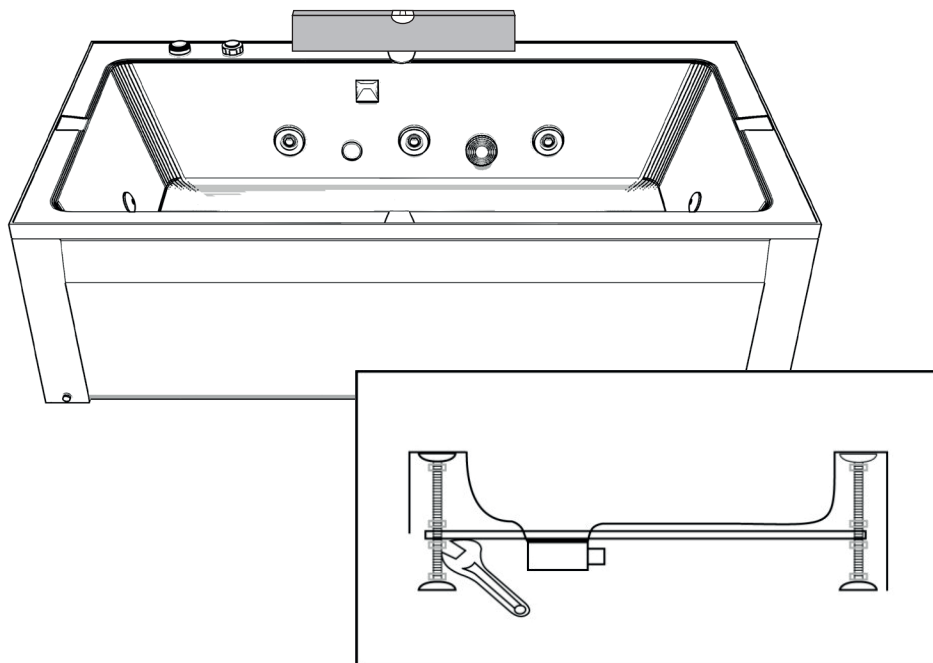

You can adjust the height of the individual feet. It is very important that the tub stands straight, does not tilt and that all feet are on the floor. It is also highly recommended that you fill the finished tub with water and check that the water drains well. Please take some time to do this.

**TIP:** To make it easier for you to push the heavy tub into the corner after setting it up, we recommend that you apply a lubricant (e.g. Fit o. Spüli) to all feet. Then the tub will „glide“ better into the corner on the tiles.

## Fitting the glass shelves and hand shower

**TIP:** Mount the glass shelves and the hand shower on the back walls **BEFORE** you place the back wall on the bath and screw it in place.

Mount the holder for the hand shower on the narrow rear wall with 2 drill holes. At the upper end of the holding rod, pull off the cover cap to insert the screw into the holder and screw it to the back wall from behind. At the lower end, insert the thread through the larger hole and screw tight from behind with the wing nut. Mount the two glass shelves with the enclosed brackets on the narrow rear wall with the 4 drill holes.

## Fitting the seals and side panels

To ensure that your shower enclosure seals tightly when in use, it is important to fit the seals supplied correctly.

The flat gaskets G1 are glued into the centre panel on the right and left in the insertion rail. They are also glued into the plug-in rail on the rear side panel C and into the front cover rail E in the rear side panel C front cover rail E in both plug-in channels.

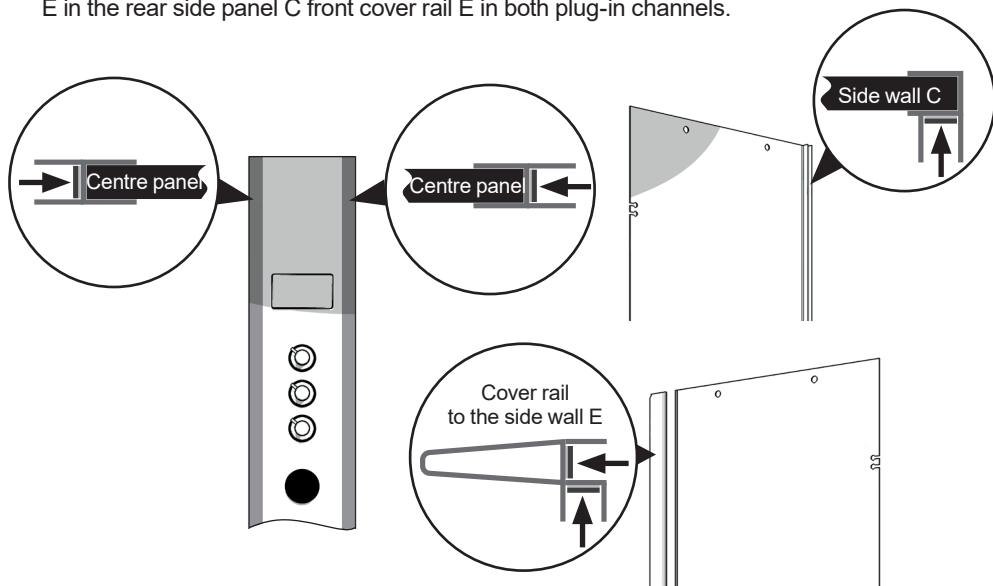

The H-seals CE2 are fitted to all narrow rear sections and to the front and rear side panels at the top and bottom respectively.

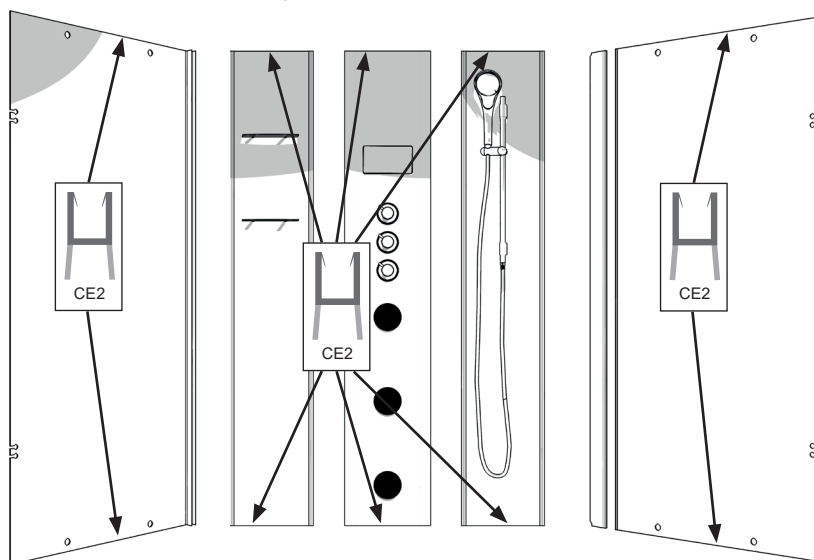

Now the narrow back panels on the right and left can be inserted into the centre panel. Please note that in both the left-hand and right-hand versions, the back panel with the hand shower is plugged into the centre panel on the right and the back panel with the glass shelves on the left. All three parts are screwed together from behind with the self-tapping screws G2 at the holes provided.

Next, insert the assembled back panel D into the rear side panel C and screw it together, also at the holes provided, with the self-tapping screws G2.

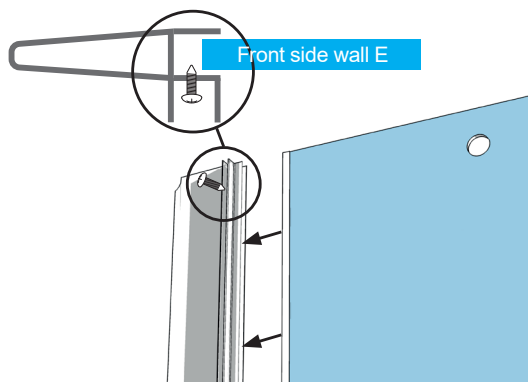
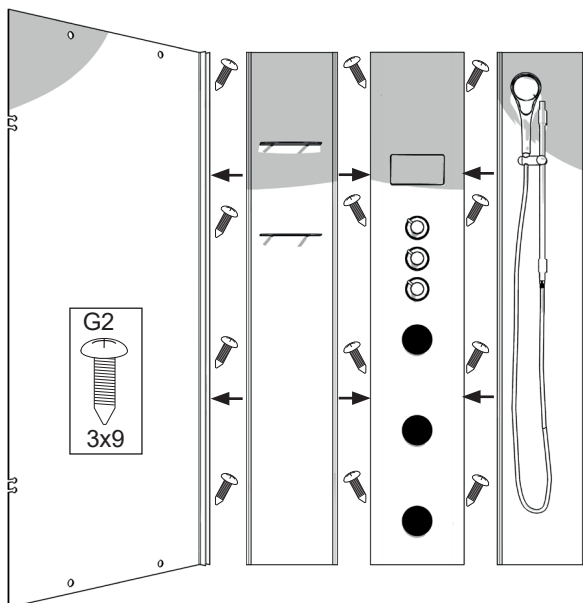

The front side panel E is now pushed into the cover rail and firmly connected to it using the 4 self-tapping screws G2. The screws are screwed into the still open insertion rail.

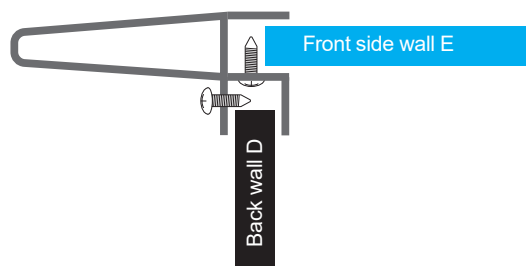

Now push the remaining open side of the rear wall D into the still free insertion rail on the cover rail which you have just connected to the front side wall E. The parts are also attached from behind. Here, too, the parts are joined together from behind at the points provided with the self-tapping screws G2.

## Fitting the lid

First screw the 6 brackets B1 to the top of the side panels C and E and the rear panel D at the points provided.

The silicone foils contained in the brackets are always placed on both sides between the metal bracket and the wall.

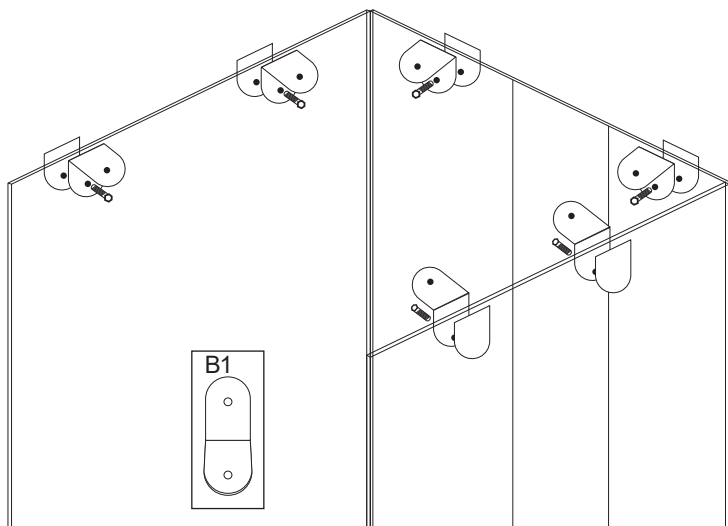

Now place the cover B on the enclosure and screw it to the angles that you have attached to the side and rear walls.

**TIP:** Do not fully tighten the screws on the brackets yet, as further adjustment of all elements will be necessary.

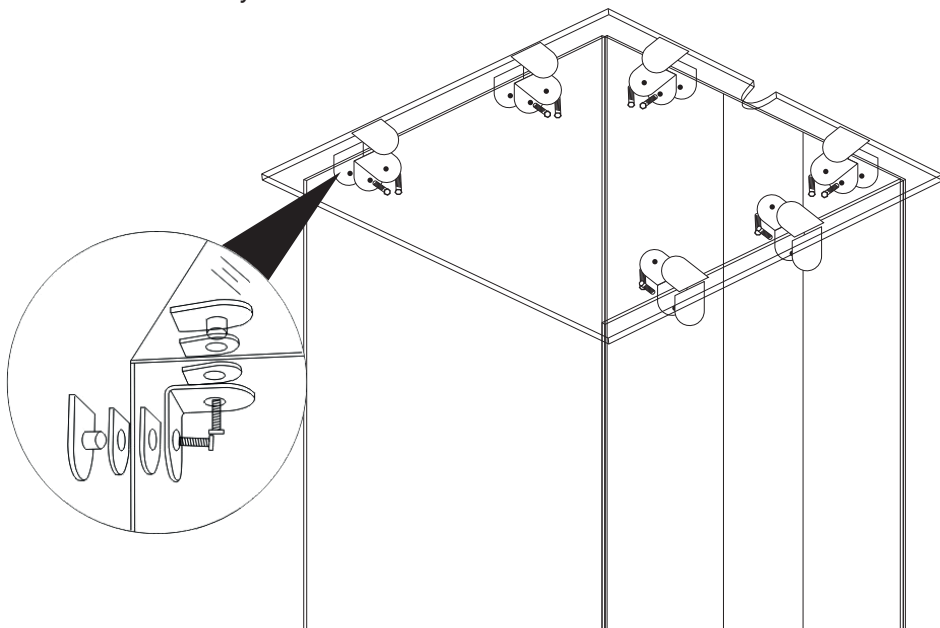

## Fitting the glass doors

You start by fitting the F5 magnetic strips. These are attached to the edges where the doors meet. The magnetic strip on the front door must be fitted so that it can be opened first. Fit the door handles F1 in the prepared holes in the doors.



Fit the W seals F3 to the top and bottom of the doors. The remaining H-W seals F4 are attached to the open edges of the shower enclosure. Please note that these are marked right and left, as the recesses for the door hinges are already incorporated. Then you can screw the door hinges F2 onto the already prepared holes of the rear and front side panel D + E.

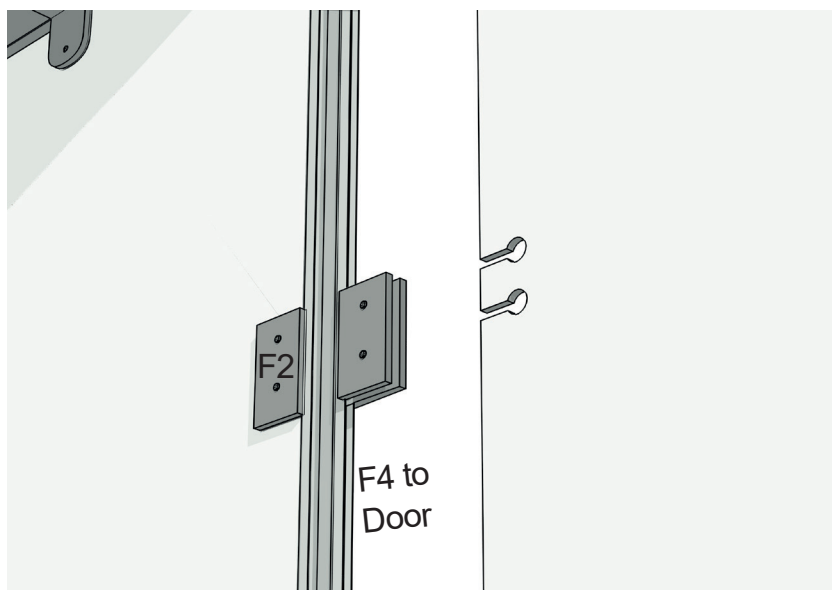

Now slide the two doors into the open side of the hinges and screw them in place.

The Allen screws should also not be tightened at first when fitting the doors. Only when everything is screwed on correctly and the door is roughly aligned, one Allen screw per hinge is tightened slightly. Now the door is aligned again before all the Allen screws are tightened.

For the door to close properly, the tub must be exactly level. Please also align the magnetic strips exactly. Finally, slide the H-W seal over the rear edge of the doors. Now it is a good idea to attach the G4 screw covers to the angles at the top and bottom.

## Connecting the shower cubicle to the bath

Now attach the brackets CE1 to the lower end of the side and rear panels.

**ATTENTION:** The two brackets on the rear wall D are mounted so that the screw connection to the bath is behind the rear wall. After complete assembly, the connection between the rear wall and the tub is no longer visible on the inside except for the cover of the angle.

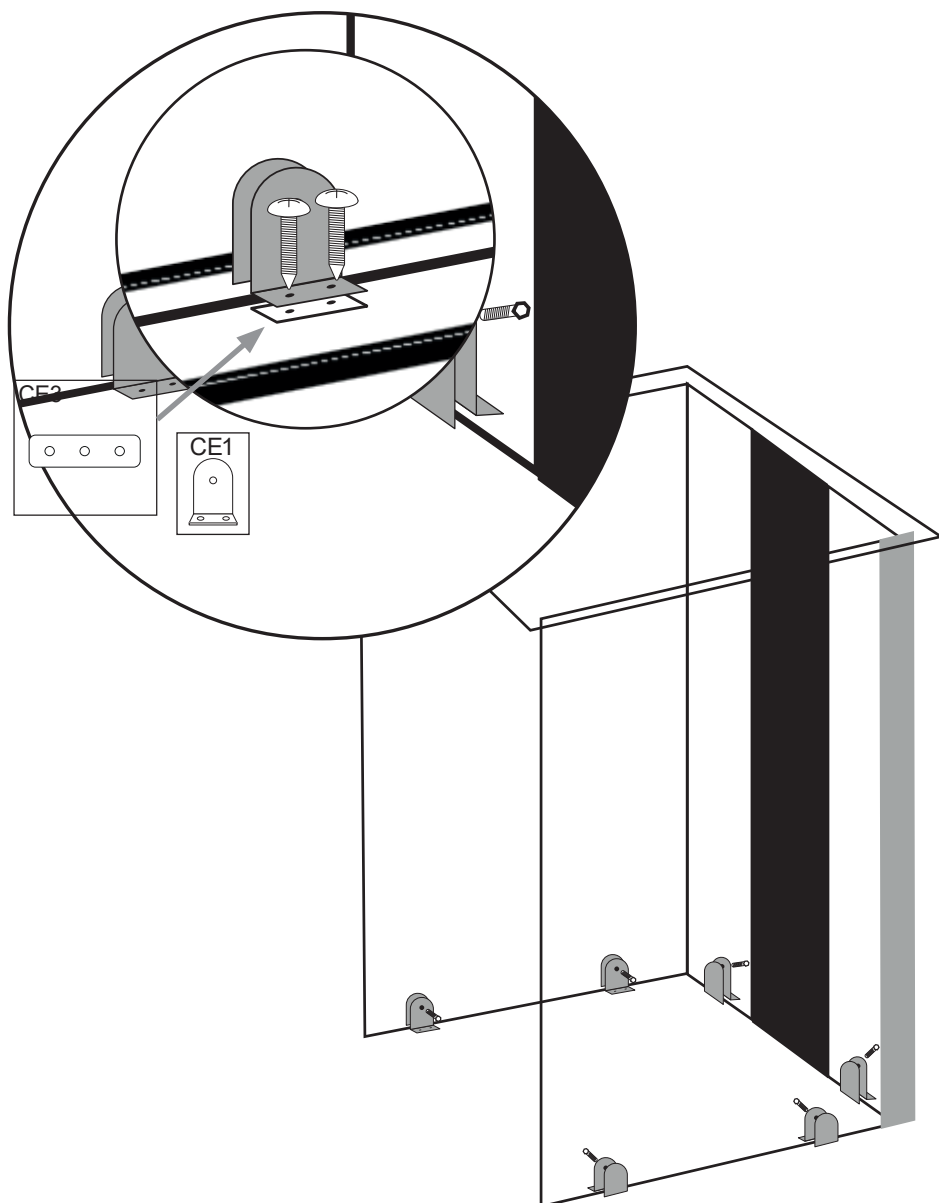

Once the brackets have been fitted, place the entire shower enclosure on the edge of the bath. The cover rail of the front side panel E should be flush with the outer right or left tub edge. Align the side walls C and E as well as the rear wall D parallel to the tub edge.

Once the walls are exactly aligned, drill the holes for the screws into the tub using a drill bit of about 2.5 mm. Place the enclosed CE3 gaskets between the angles and the tub. Once the holes have been drilled, the cabin is aligned for the last time and connected to the tub using metal brackets and G3 screws.

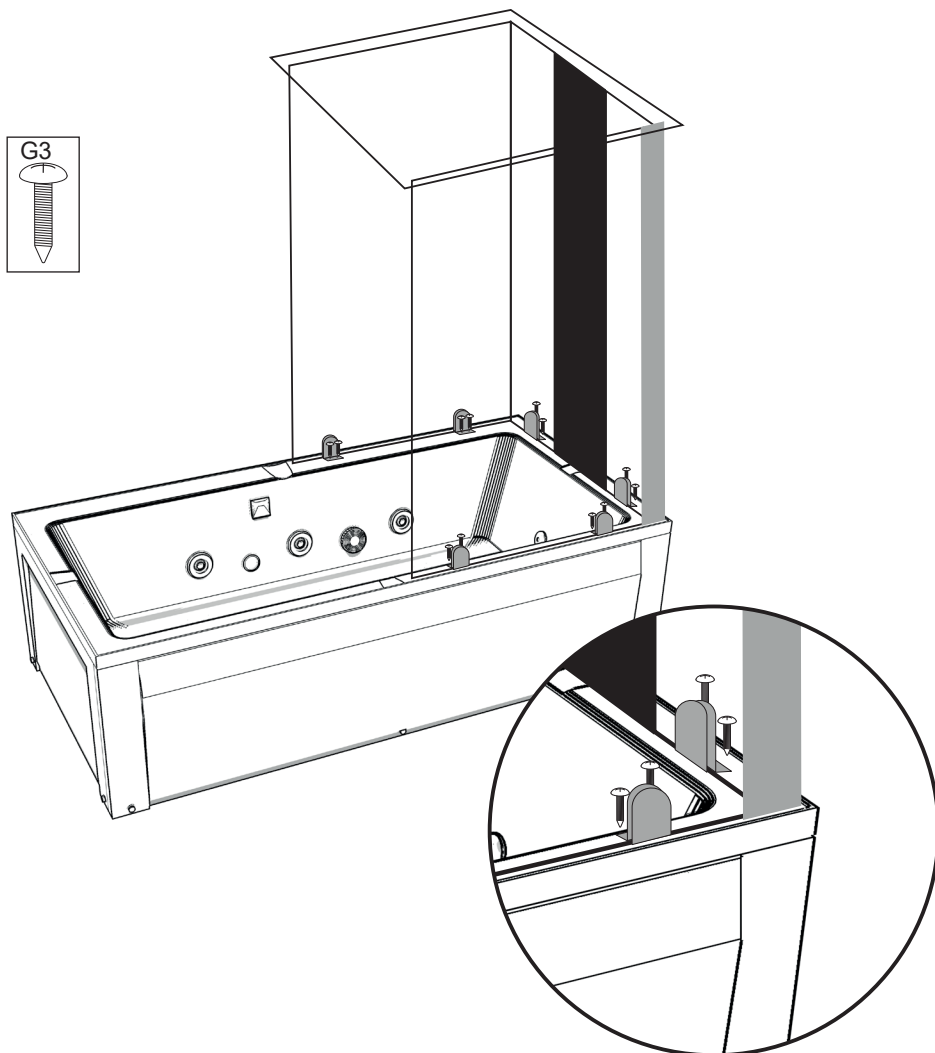



## Hose connections

The sketch shows an overview of the water connections, these are located behind the shower panel.

### Single-lever connection

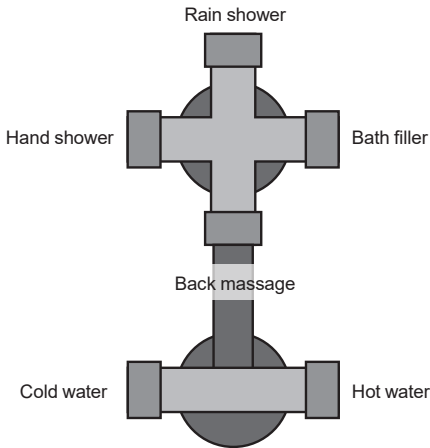

### Thermostat connection

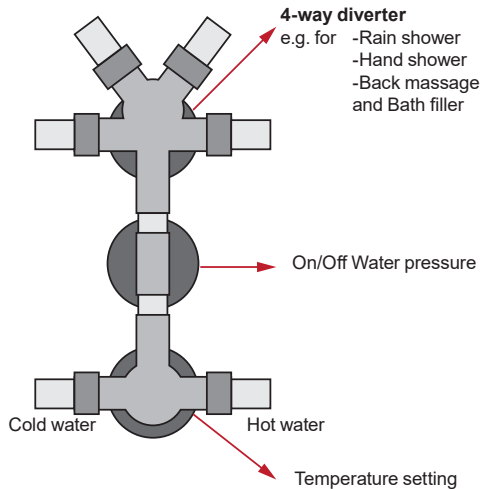

Now connect the hoses for the individual functions to the four-way distributor at the top of the fitting. Starting at the top and then going clockwise, connect the hoses in the following order. First the rain shower, then the back massage, then the bath spout and finally the hand shower. The armoured hoses for the shower water supply come to the dual connection at the bottom, with the cold water on the left at the blue point and the hot water on the right at the red point.

## Install the drain pipes

Now push the tub into place and align it once more. The drain is in the floor, but the waste pipe can also be attached to a drain in the wall, but not higher than 6 cm so that the drain is still guaranteed. The HT 50 waste water pipe used for this purpose is included in the delivery.

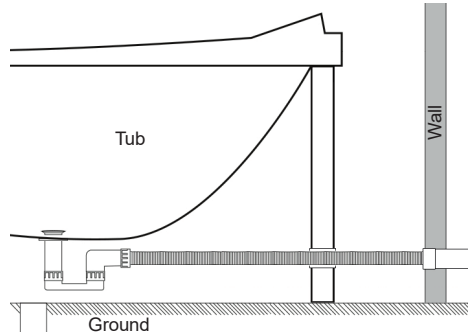
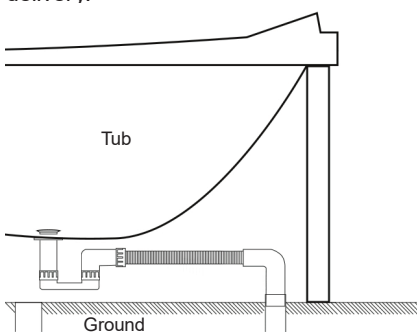

## Reattaching the skirt

When the tub is finished and professionally connected, the sides are faced again.

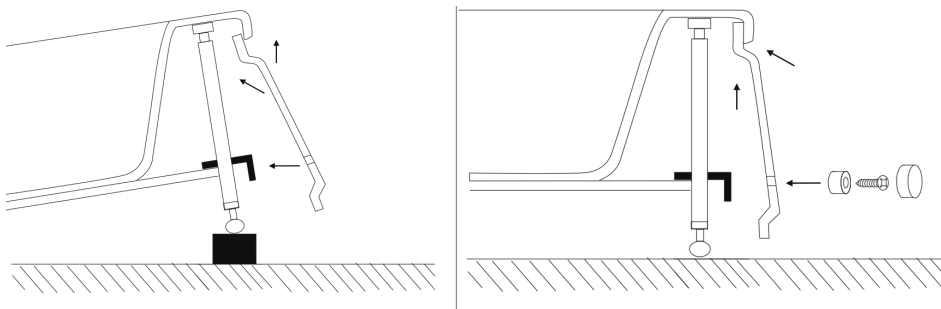

To do this, simply tilt the tub slightly and raise it to click the side panels underneath, now just fasten them with the self-tapping screws and place the cover cap on the screw.

## Connecting the cables

Wiring the shower is quite simple. All connections, which are connected to each other, are marked with small stickers. For example, „Speaker“ is connected to „Speaker“.

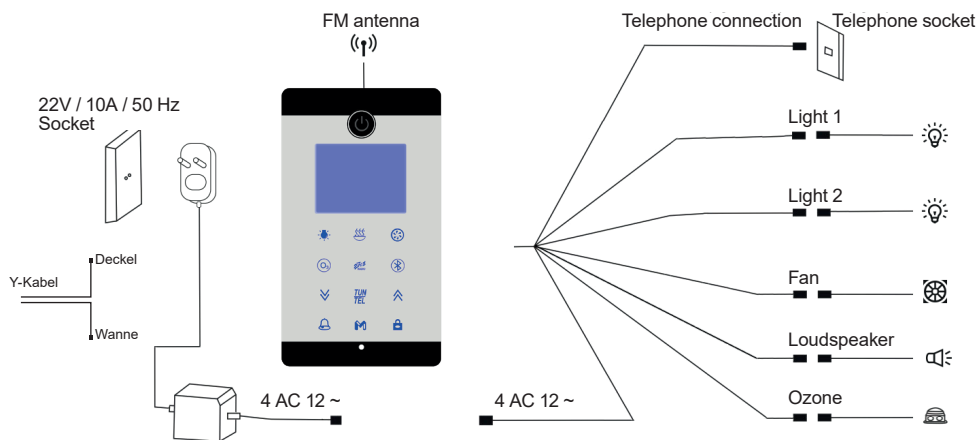

Y-cable for transformer and ozone

# Bediendisplay

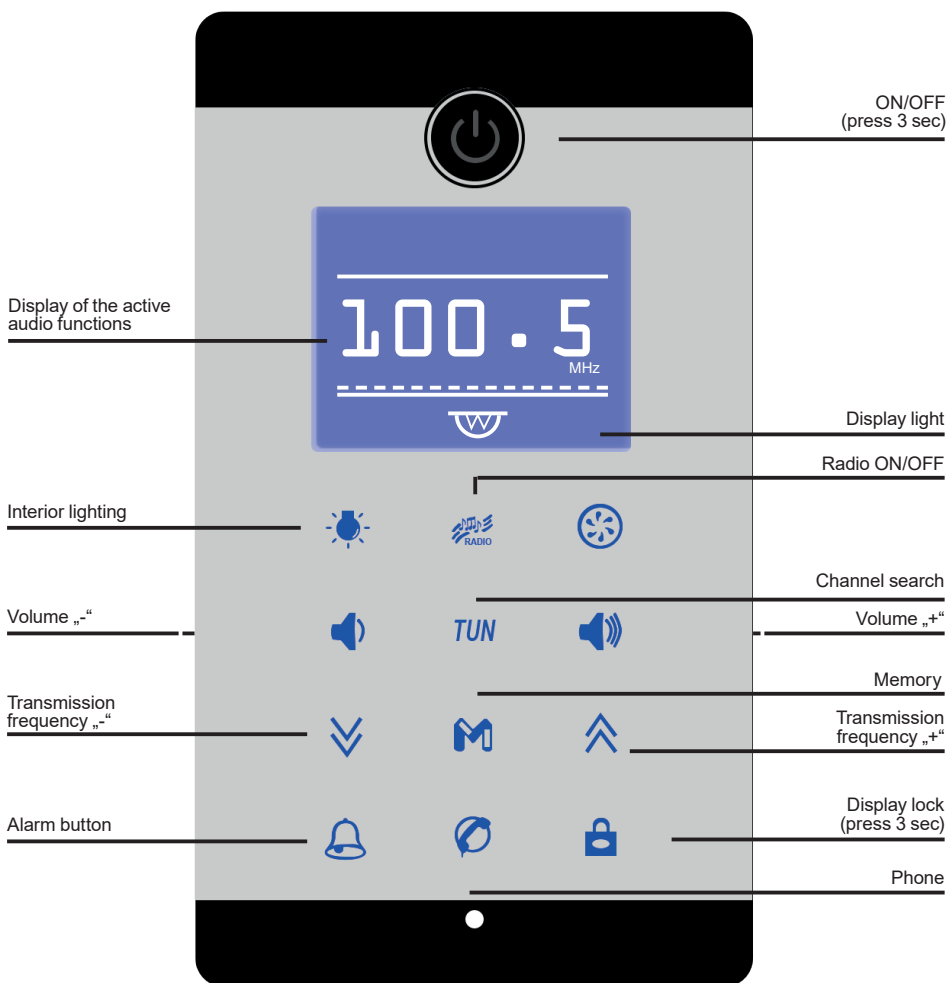

## Display Key lock

Please note that when switching on, the key must be pressed until the signal tone sounds. Only then can you operate the other keys.

After a relatively short time, if you do not operate the display, the key lock switches on automatically. You can also hear this by the signal tone. To be able to operate the display again, it is necessary to press the lock symbol (bottom right in the picture) until a signal tone is emitted here as well. Only then are the keys „released“ again and you can operate the keys.

Please note that it is not sufficient to tap the key lock briefly (light goes on). You must wait until you hear the signal tone!

## Ozone cleaning

After you have switched off the display, the ozone cleaning starts automatically and switches off again after the cleaning process.

## Start-up/leak test

For the leak test, please now connect the water and the waste water with the hose connections. It is important that the tub continues to stand away from the wall so that you can still get behind the shower cubicle.

Before you put the pipe under water pressure, please note that the shower panel has only been pre-assembled by the factory to make it easier for you to assemble it. It is absolutely necessary that you recheck all screw connections and tighten them if necessary. This applies to the nozzles and the clamps. Only when all this has been checked may you open the water.

Now test all the functions that have to do with water, one after the other. Check the hand shower, then the rain shower and the back massage. It is best to do this in pairs. One stands in front of or inside the shower cubicle, the other stands behind the shower cubicle and looks at the hose connection and the function that is currently being tested. If a screw connection is not properly sealed, check whether

the seal in the fitting is correctly seated and whether it is screwed tightly enough. After the leak test, the electrical functions can now be tested. If the plug is plugged in, you can test the light, radio, etc.

Finally, push the tub into its final position. We recommend a silicone joint between the edge of the tub and the wall.

## Maintenance and cleaning of the tub/shower

1. Clean the tub and shower enclosure with a mild liquid detergent and a soft cloth.  
Caution: Never use acetone, cleaning agents containing ammonia or coarse-grained scouring agents!
2. Clear the drain regularly of hair and the like to prevent clogging.
3. Use an acrylic care product for the tub and the panel to protect the surface from scratches. „Lotus -Effect Set“ Put an end to dirt deposits, limescale/water stains!

### „Lotus effect set“ against dirt deposits, limescale/water stains

#### Contents:

1x NANO NT GLASS & CERAMIC (easy to clean)

1x NANO NT CLEANER

1x CLEANING WIPE

1x POLISHING CLOTH

1x PROTECTIVE HAND SHOES

Resistant to steam cleaners \* Very durable long-term protection \* Lasts for many months, depending on use \* Minimal care and cleaning effort \* No more expensive cleaning agents required \* Dirt can no longer adhere or is easier to clean (easy-to-clean) \* Very easy to use



THE NANO NT GLASS & CERAMIC 2 COMPONENT SET is a coordinated cleaning and surface finishing system which generates a very high-quality and long-lasting „easy-to-clean-effect“ on glass and ceramic surfaces.

The applied material creates a thin film on the surface that reduces the adhesion of dirt and foreign substances and allows water to roll off better.

- Small scratches can be polished with e.g. toothpaste and a soft cloth.
- Make sure that the drains, which are located in the centre of the bathtub underneath the rear walls, are always open. Otherwise, if they become blocked, the water will not drain back into the inside of the tub. There is a risk that too much water will accumulate and then run out over the protective wall.
- Before using the whirlpool system for the first time, it should be rinsed with disinfectant. It is then sufficient to repeat the disinfection after approx. 5 baths. Disinfection should also be carried out if the whirlpool system is not used for a longer period of time.

## **You can order our “Lotus -Effect Set” at:**

**E-Mail:** kundenservice@seniorbad.de

**Online shop:** [www.seniorbad.de](http://www.seniorbad.de)

**Phone:** +49 35795 - 179 600

**Fax:** +49 35795 - 179 699

## **Security information on the use of Bluetooth devices**

Bluetooth connections can be the target of an attack, through which personal data on the device such as stored text messages, emails, diaries or the phone book can be spied out. Misuse of the device, such as unauthorised phone calls at the expense of others, is also conceivable.

### **Security measures**

- Update the operating system of your Bluetooth-enabled devices at regular intervals
- Always deactivate the Bluetooth interface after use
- Do not pair with unknown devices
- Switch to invisible mode when activating Bluetooth
- Do not authorise any data transmission from unknown sources
- Install malware protection on your Bluetooth devices

## **Warranty and service**

We grant a 2-year warranty for our products. A warranty period of 6 months applies to wear parts such as seals, hand showers, shower hoses and rollers. The costs for replacement are not covered. Spare parts can be ordered from our customer service.

Defects that can be traced back to calciferous or iron-rich water are excluded from the warranty. Please describe the spare part exactly - preferably add the short designation (letter/number) used in this booklet as well as the exact type of cabin (e.g. K05). We are always open to your comments and suggestions.

### **Note**

Each pool is assembled, connected, tested and repacked at the factory for testing purposes. As our products undergo several checks during manufacture, small amounts of residual water may be present in parts of the product.

# Recycling of electrical and electronic appliances

## Information for private households

The Electrical and Electronic Equipment Act (ElektroG) contains a large number of requirements for the handling of electrical and electronic equipment. The most important ones are summarised here.

### 1. Separate collection of old appliances

Electrical and electronic equipment that has become waste is referred to as waste equipment. Owners of old appliances must dispose of them separately from unsorted municipal waste. In particular, old appliances do not belong in household waste, but in special collection and return systems.

As a rule, owners of old appliances must separate used batteries and accumulators that are not enclosed by the old appliance before handing them in at a collection point. This does not apply if the waste equipment is handed in to public waste management authorities and separated there from other waste equipment for the purpose of preparing it for reuse.

### 2. Options for the return of waste appliances

Owners of old appliances from private households can hand them in at the collection centres of the public waste disposal authorities or at the take-back points set up by manufacturers or distributors within the meaning of the ElektroG.



### 3. Data protection notice

Old appliances often contain sensitive personal data. This applies in particular to information and telecommunications technology devices such as computers and smartphones. In your own interest, please note that each end user is responsible for deleting the data on the old appliances to be disposed of.

### 4 Meaning of the „crossed-out wheeled bin“ symbol



The symbol of a crossed-out wheeled bin regularly shown on electrical and electronic equipment indicates that the respective device must be collected separately from unsorted municipal waste at the end of its service life.

### 5. Producer registration number

As a manufacturer within the meaning of the ElektroG, we are registered with the responsible Stiftung Elektro-Altgeräte Register (Nordostpark 72, 90411 Nuremberg) under the following registration number: WEEE-Reg. No. DE65757710



## EU-Konformitätserklärung



gemäß folgenden EU-Richtlinien:

**2014/35/EU EU-Niederspannungs-Richtlinie/ Low Voltage Directive**

**2014/30/EU Elektromagnetische Verträglichkeit von Elektro- und Elektronikprodukten/  
Electromagnetic Compatibility Directive**

**2014/53/EU Funkgeräte-Richtlinie / Radio Equipment Directive**

Hiermit erklären wir, dass die nachstehenden bezeichneten Produkte in ihrer Konzeption und Bauart sowie in der von uns in Verkehr gebrachten Ausführung den grundlegenden Sicherheits- und Gesundheitsanforderungen der EU-Richtlinien entsprechen. Bei einer mit uns nicht abgestimmten Änderung des Produktes verliert diese Erklärung ihre Gültigkeit.

**Hersteller:**

SeniorBad GmbH  
Grenzstraße 11  
01936 Laußnitz  
Deutschland  
Tel. : 035795 - 179 600  
E-Mail: info@seniorbad.de

Die alleinige Verantwortung für die Ausstellung dieser Konformitätserklärung trägt der Hersteller.

**Produktmodelle: D37, D38, D46, D58, D60, K05**

Die oben genannten Produktmodelle verwenden folgende harmonisierte Normen und erfüllen damit die Anforderungen zur CE- Kennzeichnung:

**2014/35/EU EU-Niederspannungs-Richtlinie/ Low Voltage Directive**

EN IEC 60335-2-105:2021+A11:2021,  
EN 60335-1:2012+A11:2014+A13:2017+A1:2019+A14:2019+A2:2019+A15:2021  
EN 62233:2008

**2014/30/EU Elektromagnetische Verträglichkeit von Elektro- und Elektronikprodukten/  
Electromagnetic Compatibility Directive**

EN IEC 55014-1:2021, EN IEC 61000-3-2:2019+A1:2021, EN 61000-3-3:2013+A1:2019+A2:2021  
EN IEC 55014-2:2021

**2014/53/EU Funkgeräte-Richtlinie / Radio Equipment Directive**

EN IEC 62368-1:2020+A11:2020, EN 62479:2010, EN 301 489-1 V2.2.3, EN 301 489-17 V3.2.4  
EN 300 328 V2.2.2

Erfüllung aller Vorgaben laut Richtlinie.

Verantwortlicher Geschäftsführer  
Alexander Jentho

Stand 02.04.2024